

PROJETO MOBILIÁRIO

CASA LAR

ARQUITETO: ARNILDO DEMUTH JR. CAU: 120850-0 CRUZ MACHADO - 2019

000058

01 un Armário em MDF Murano de 15mm, com prateleiras (FIG 01)

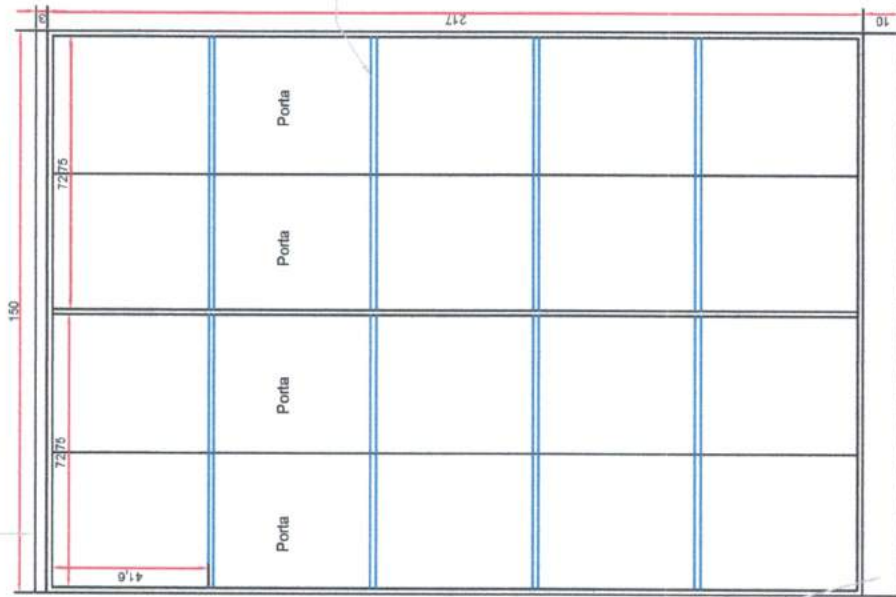

Vista Frontal

Rodapé em madeira de pinheiro revestido com granito verde pavão

01 un Armário em MDF, estrutura Murano de 15mm, porta e gavetas em MDF Ébano Exótico de 15mm (FIG 01)

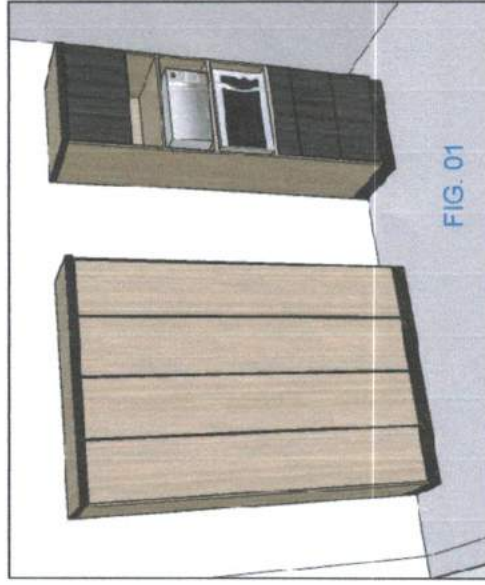

Rodapé em madeira de pinheiro revestido com granito verde pavão

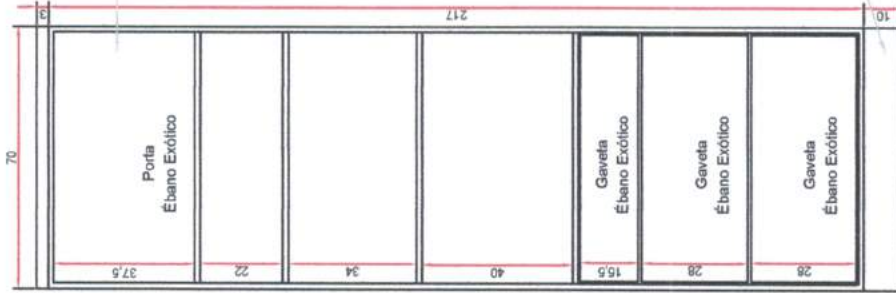

Vista Frontal

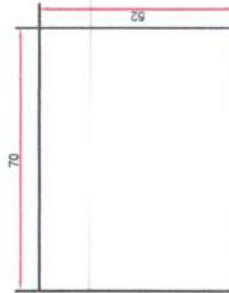

Vista Superior

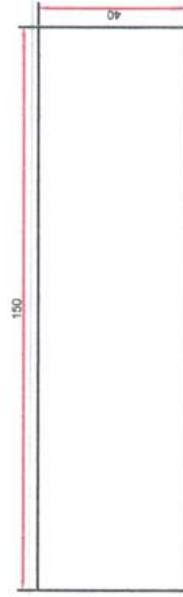

Vista Superior

000059

ARQUITETO:

Arnildo Demuth Jr

CAU:

A 120850-0 CREAS

CLIENTE:

Casa Lar

AMBIENTE:

ESCALA:

1/20

DATA:

26-07-2019

01 un Armário aéreo em MDF Murano de 15mm. (FIG 02)

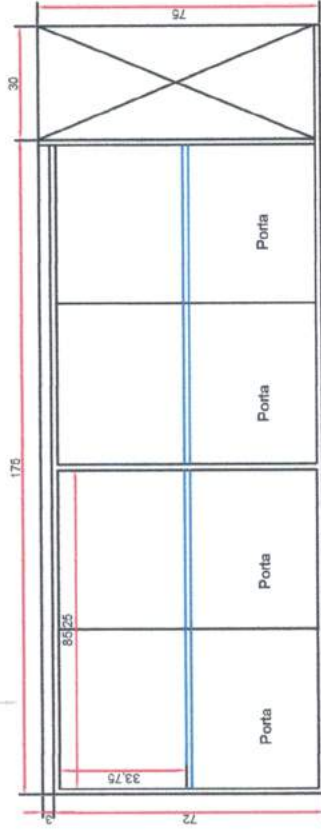

Vista Frontal



Vista Superior

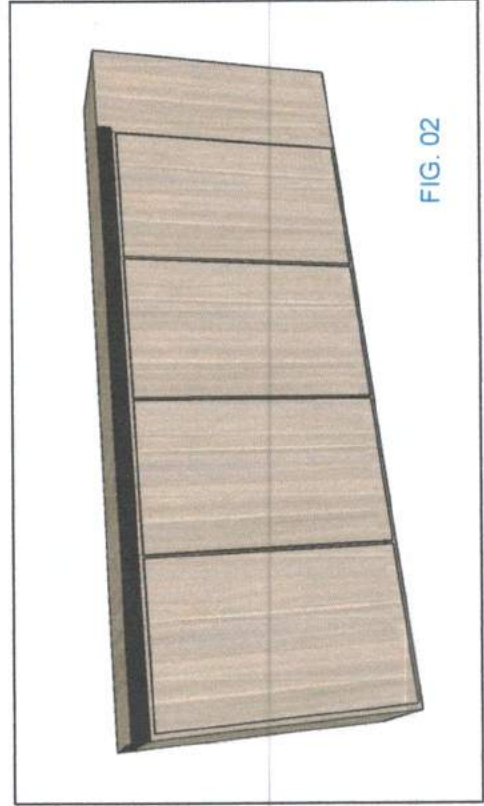
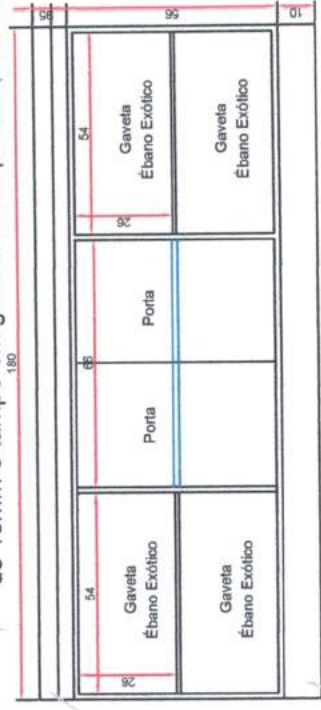
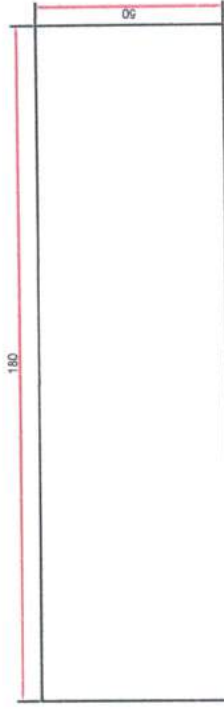

FIG. 02

01 un Armário em MDF estrutura e portas Murano de 15mm, com frente de gavetas em MDF Ébano Exótico de 15mm e tampo em granito verde pavão (FIG 03)



Vista Frontal



Vista Superior

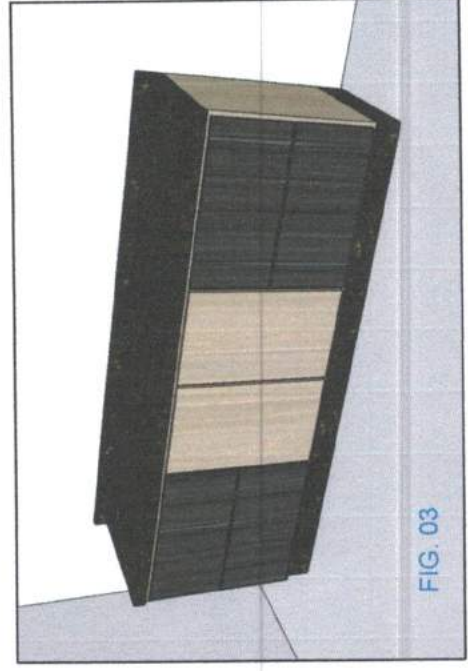

FIG. 03

Roda parede em granito verde pavão

Rodapé em madeira de pinheiro revestido com granito verde pavão

000060

ARQUITETO:

Arnildo Demuth Jr

CAU:

A 120850-0

CLIENTE:

CREAS

AMBIENTE:

Casa Lar

ESCALA:

1/20

DATA:

26-07-2019

01 un Armário aéreo em MDF, estrutura e 3 portas Murano de 5mm,
 2 portas em MDF Ébano Exótico de 15mm (FIG 04)

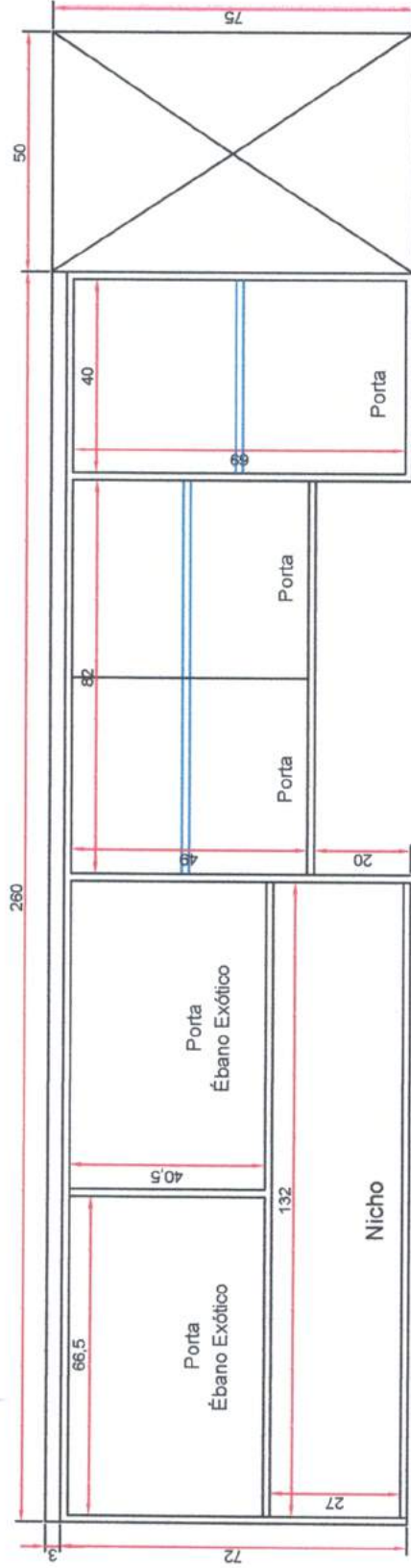

Vista Frontal

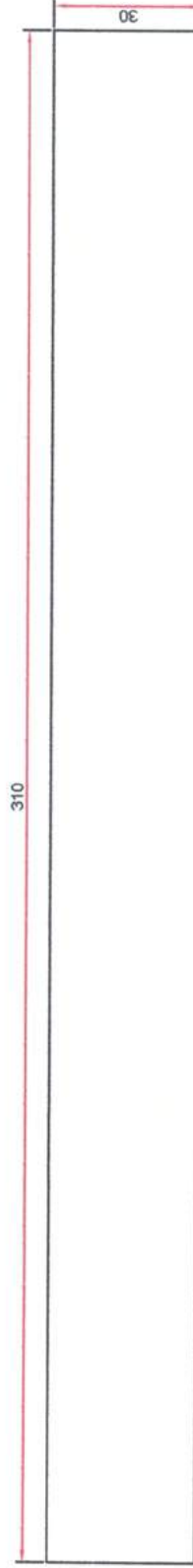

Vista Superior

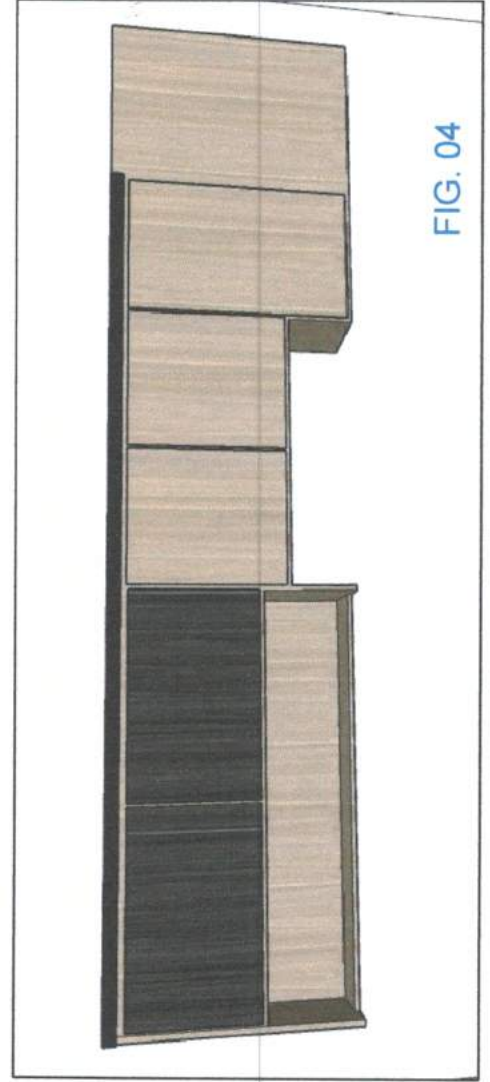

FIG. 04

000061

ARQUITETO:

Arnildo Demuth Jr

CAU:

A 120850-0 CREAS

CLIENTE:

Casa Lar

AMBIENTE:

Casa Lar

ESCALA:

1/15

DATA:

26-07-2019

01 un Armário aéreo em MDF, estrutura e 1 porta Murano de 15mm,
 2 portas em MDF Ébano Exótico de 15mm (FIG 05)

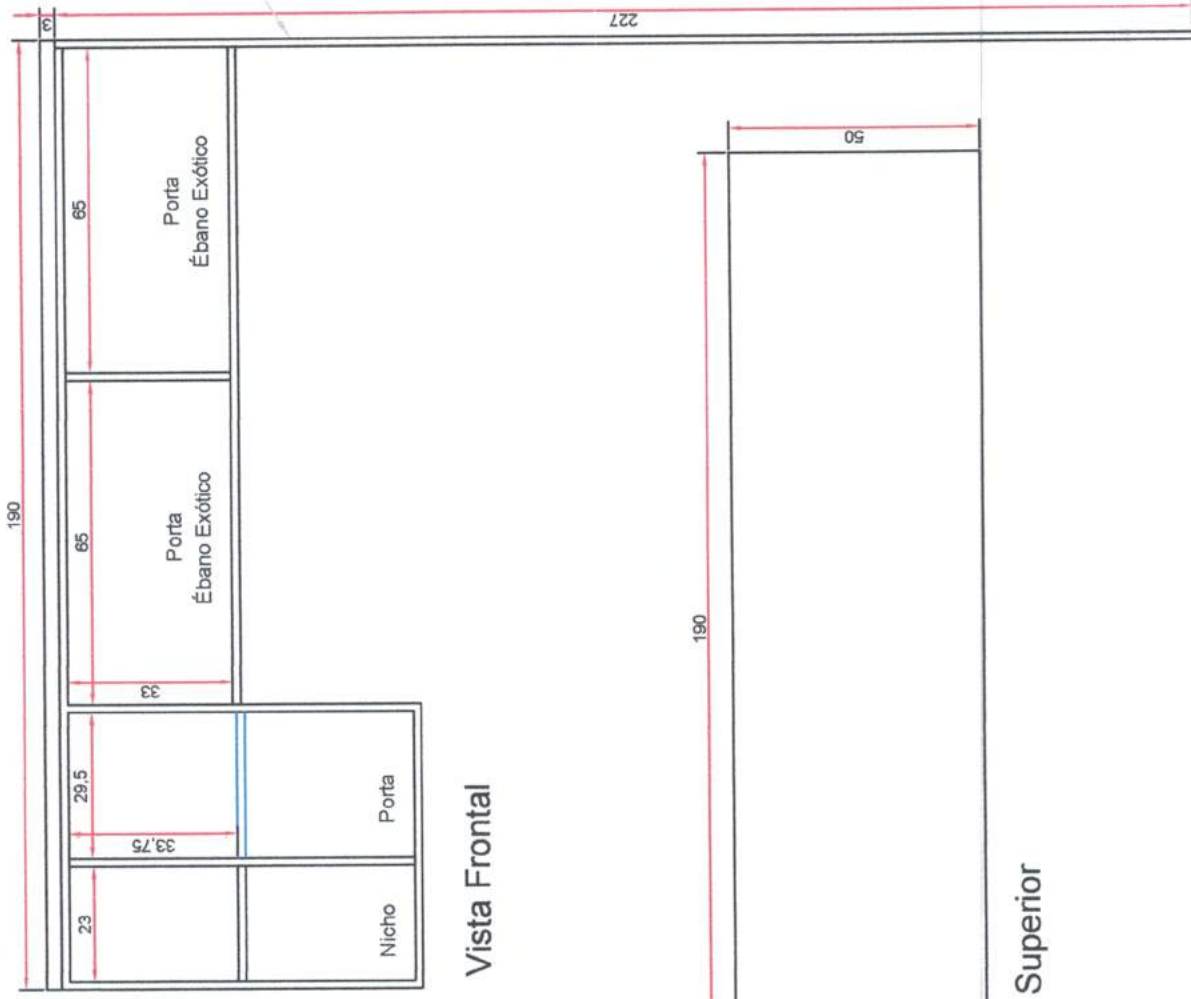

Vista Frontal

Vista Superior

Lateral da geladeira

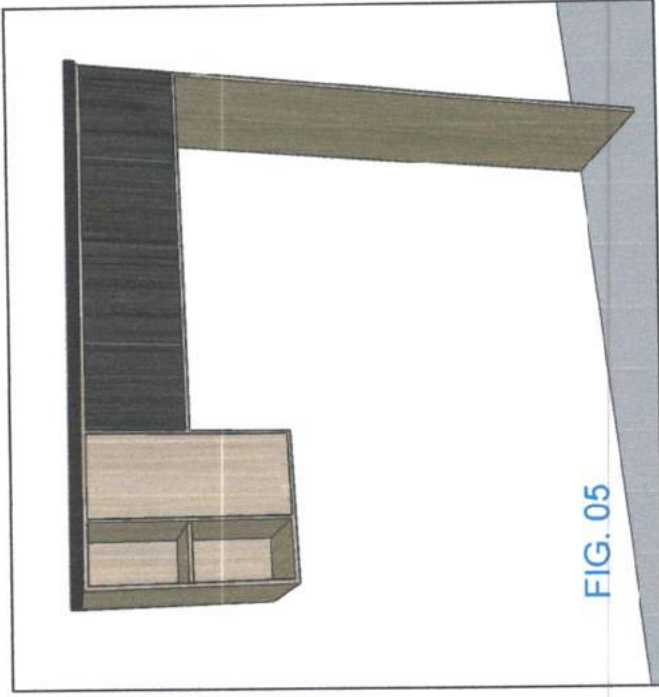

000006

ARQUITETO: Arnildo Demuth Jr	CAU: A 120850-0	CLIENTE: CREAS	AMBIENTE: Casa Lar	ESCALA: 1/15	DATA: 26-07-2019
--	---------------------------	--------------------------	------------------------------	------------------------	----------------------------

01 un Armário em MDF Murano de 15mm, com tampo em granito verde pavão (FIG 06)

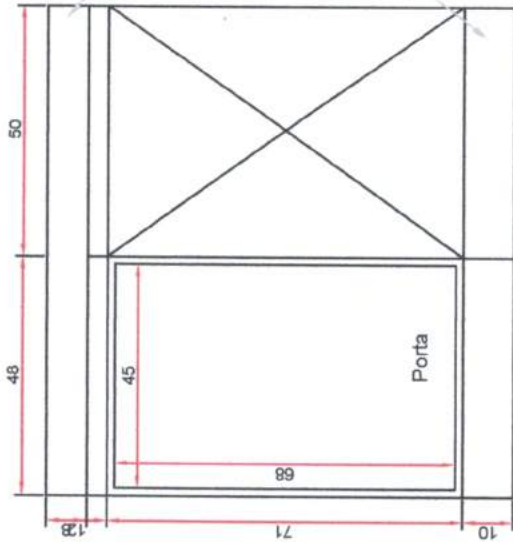

Vista Frontal

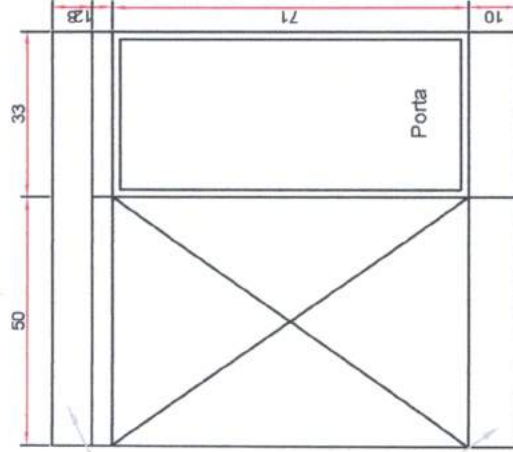

Vista Frontal

Roda parede em granito verde pavão

Rodapé em madeira de pinheiro revestido com granito verde pavão

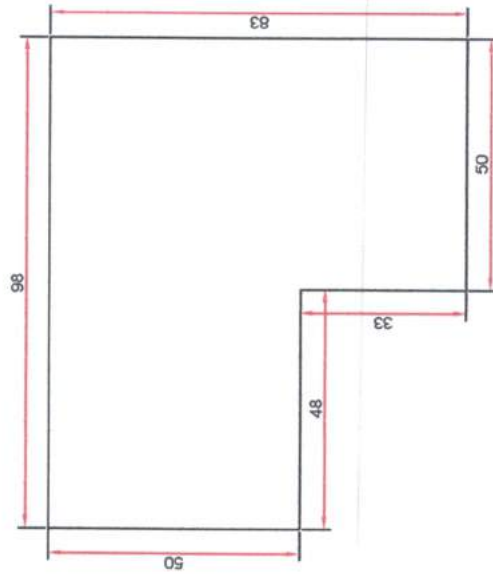

Vista Superior

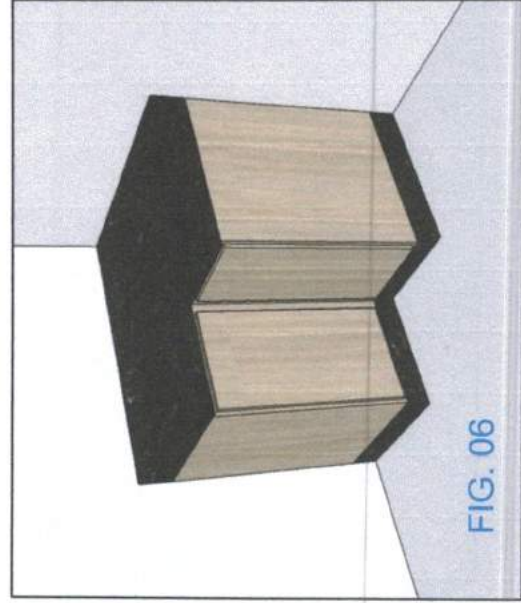

FIG. 06

000063

ARQUITETO:

Arnildo Demuth Jr

CAU:

A 120850-0

CLIENTE:

CREAS

AMBIENTE:

Casa Lar

ESCALA:

1/15

DATA:

26-07-2019

01 un Armário em MDF Murano de 15mm, com tampo em granito verde pavão (FIG 07)

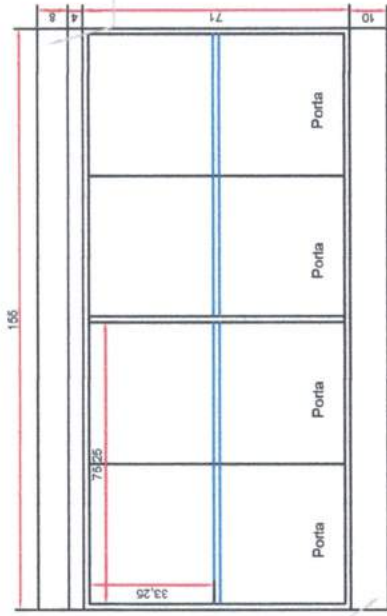

Vista Frontal

Vista Superior

Rodapé em madeira de pinheiro revestido com granito verde pavão

01 un Armário em MDF Murano de 15mm, com frente de gavetas em MDF Ebanó Exótico de 15mm e tampo em granito verde pavão (FIG 07)

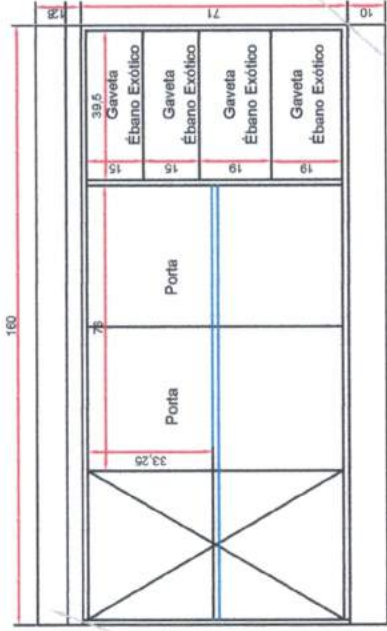

Vista Frontal

Vista Superior

Rodapé em madeira de pinheiro revestido com granito verde pavão

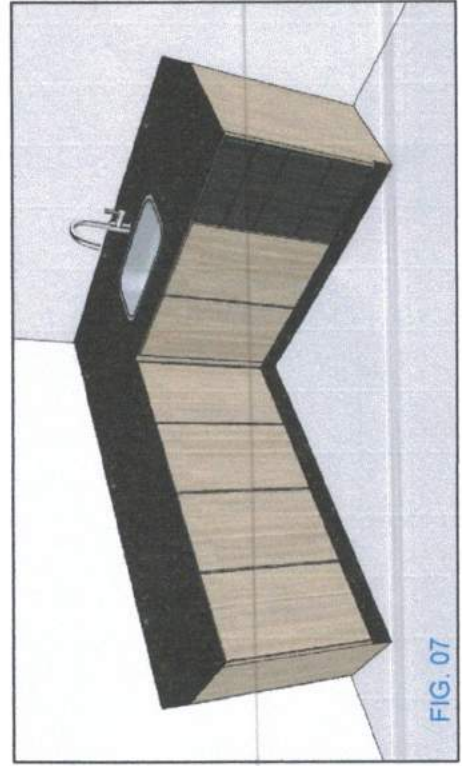

000064

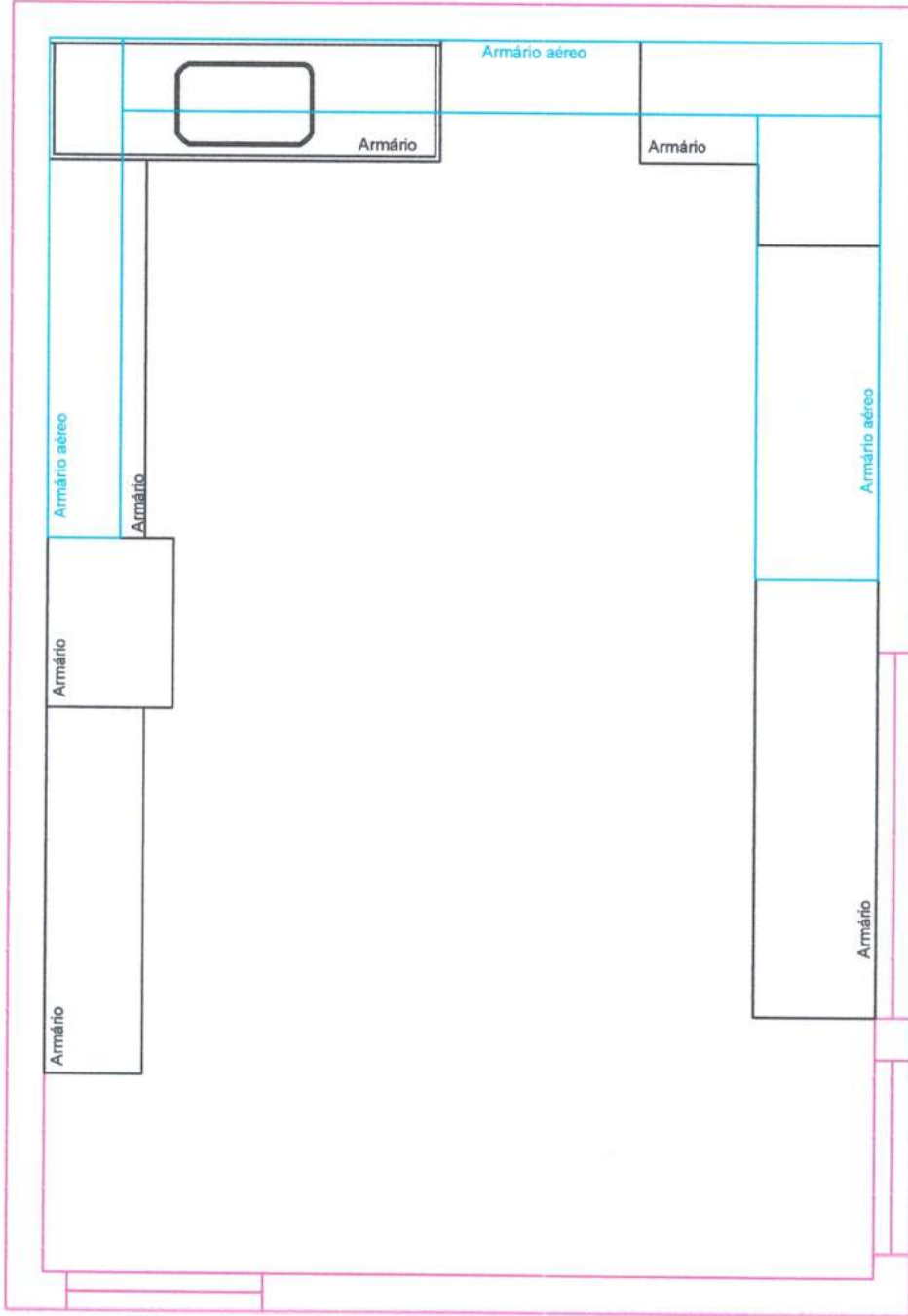

000065

ARQUITETO:

Arnildo Demuth Jr

CAU:

A 120850-0

CLIENTE:

CREAS

AMBIENTE:

Casa Lar

ESCALA:

1/30

DATA:

26-07-2019

PROJETO MOBILIÁRIO

CREAS

000066

ARQUITETO: ARNILDO DEMUTH JR CAM: 120850-0 CRUZ MACHADO - 2019

Regra para todas as peças e ambientes conforme necessário:

- ✓ Fundo do móvel com MDF ou EUCATEX 3 mm
- ✓ Dobradiças de pressão 35 mm
- ✓ Todas as gavetas com corrediças telescópicas
- ✓ Puxador Perfil fosco com ponteira de acabamento
- ✓ Reforços internos e rodapés em madeira de pinheiro
- ✓ Parte interna dos móveis pode ser em MDF Branco TX

✓ Deverão ser conferidas as medidas no local

01 un Revisteiro suspenso em MDF branco Iceland de 15mm, (Fig 01)

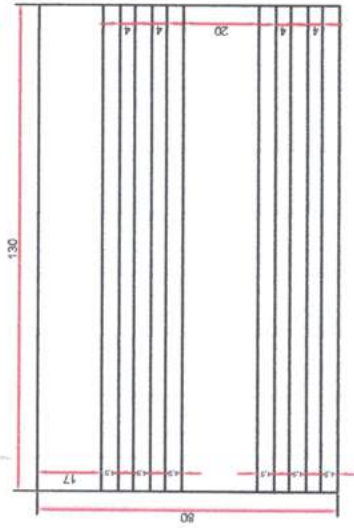

Vista Frontal

Vista Superior



Vista Lateral

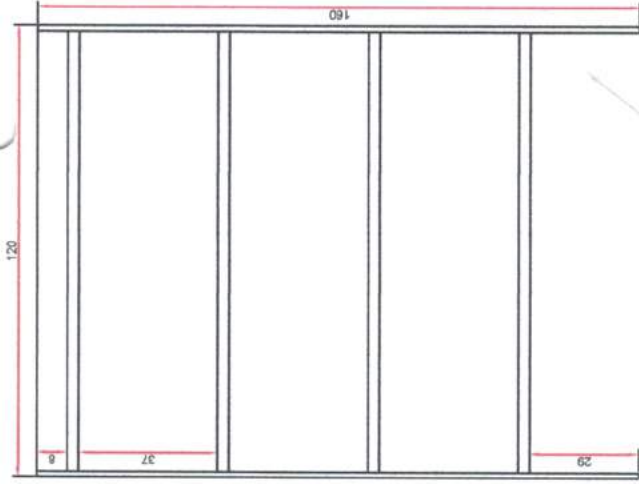

Vista Frontal

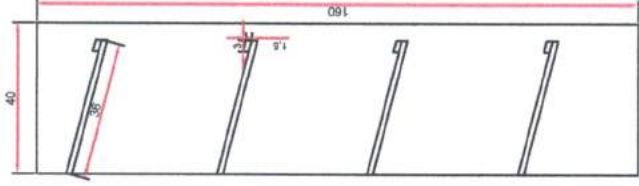

Vista Lateral

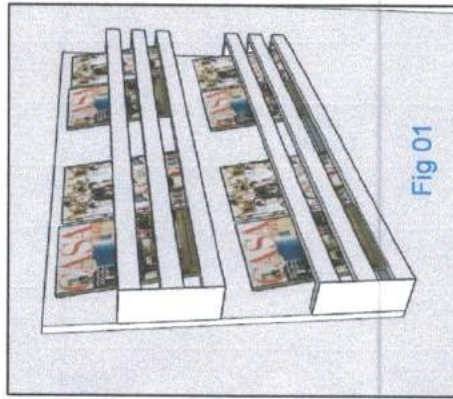

Fig 01

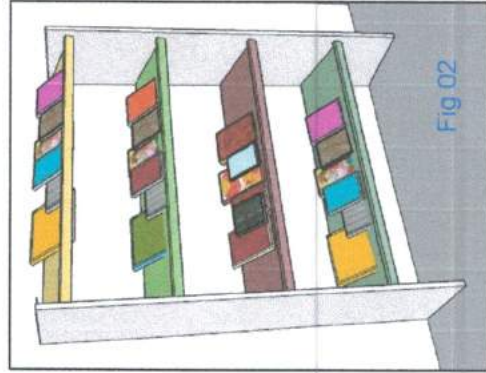
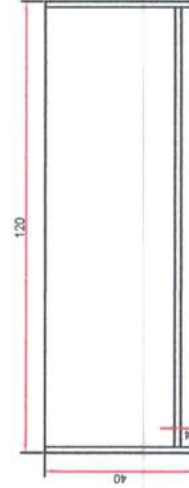

Fig 02

01 un Prateleira p/ livros em MDF branco Iceland, 15mm, divisórias pintadas nas cores azul pastel, amarelo pastel, verde pastel e rosa pastel, c/ borda de 1,5x3cm p/ apoiar o livro (Fig 02)



Vista Superior

000068

01 un Biombo com estrutura em madeira pintado na cor branca (Fig 03)

Madeira de pinheiro pintado de branco

MDF 3mm pintado de branco

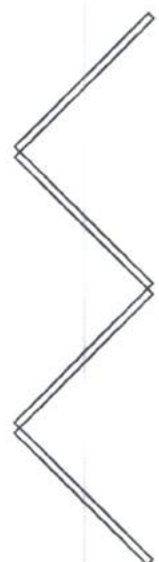
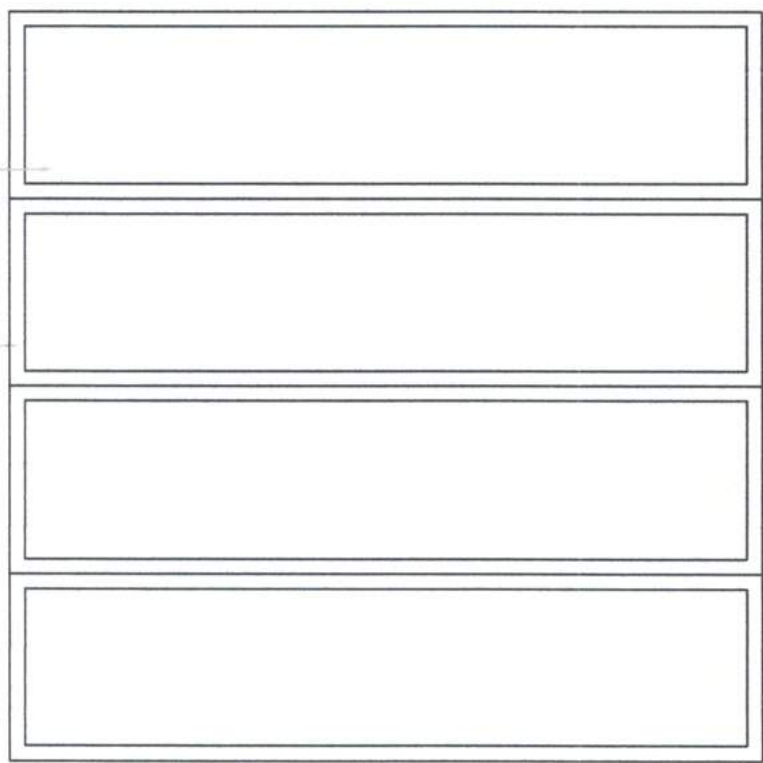

01 un Estante em MDF branco Iceland, 15mm (Fig 04)

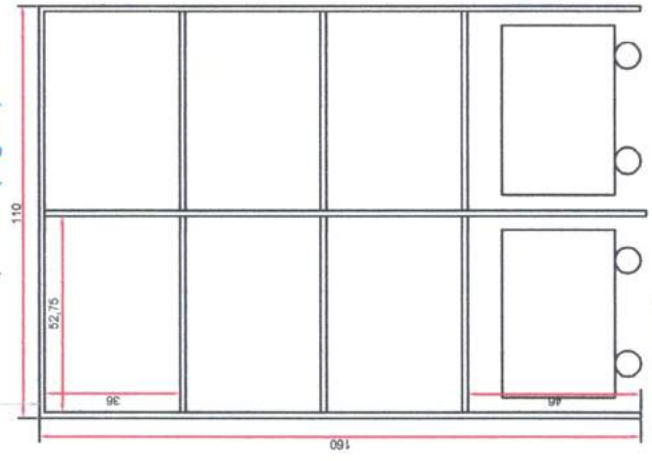

Vista Superior



02 un Caixa p/ brinquedos em MDF pintado e com rodizio de silicone 5 cm (1 rosa pastel e 1 verde pastel) (Fig 04)

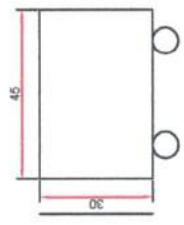

Vista Superior

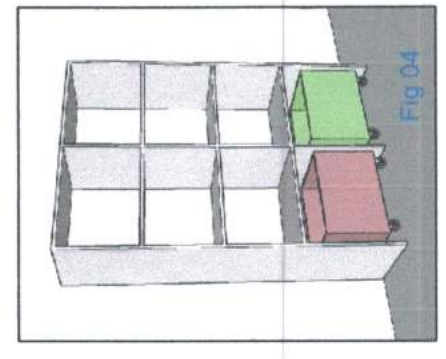
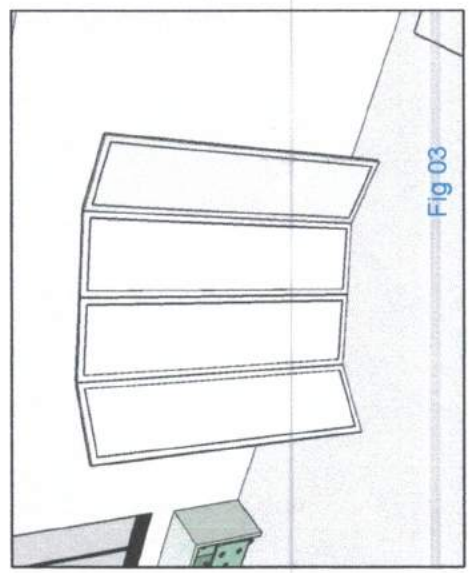
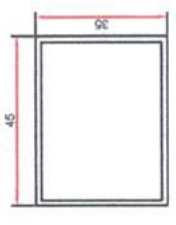

000069

ARQUITETO:

CAU:

CLIENTE:

AMBIENTE:

ESCALA:

DATA:

Arnildo Demuth Jr A 120850-0 CREAS

Sala Multiuso

1/20

26-07-2019

01 un Armário em MDF branco Iceland de 15mm, com prateleiras. (Fig 05)

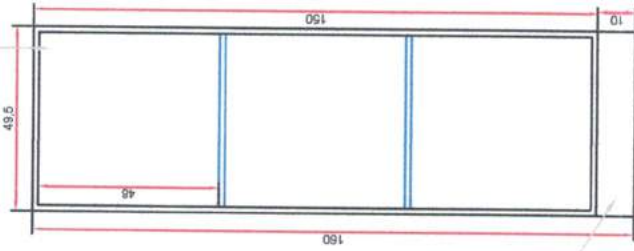

Rodapé em madeira de pinheiro revestido c/ fórmica branca TX

Vista Frontal

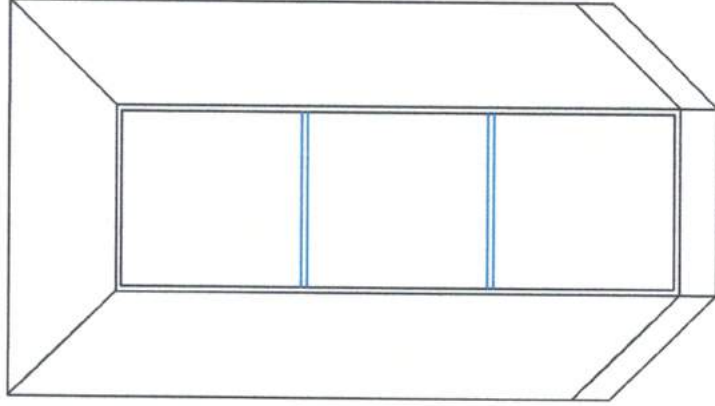

Vista Frontal imagem ilustrativa

01 un Armário em MDF branco Iceland de 15mm, com 1 porta pintada em azul pastel, com prateleiras. (Fig 05)

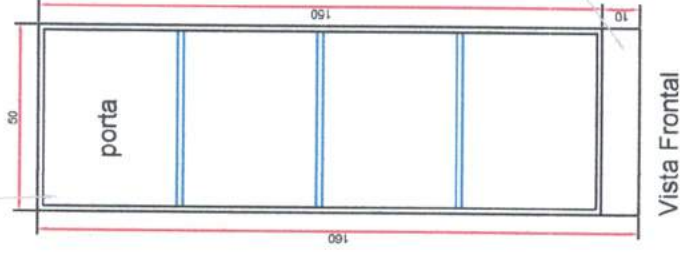

Rodapé em madeira de pinheiro revestido c/ fórmica branca TX

Vista Frontal

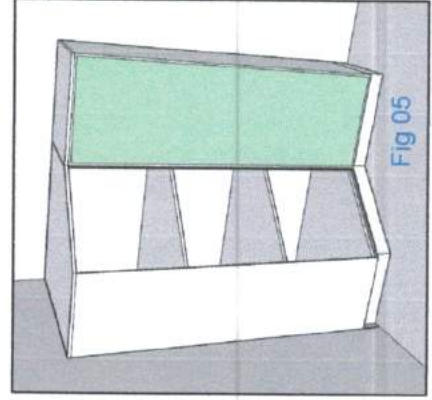
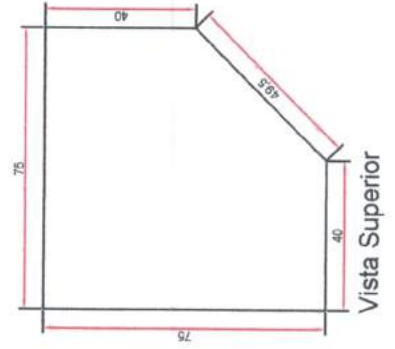
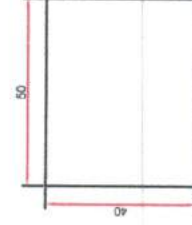

Fig 05



Vista Superior



Vista Superior

000070

ARQUITETO:

Arnildo Demuth Jr

CAU:

A 120850-0

CLIENTE:

CREAS

AMBIENTE:

Sala Multiuso

ESCALA:

1/20

DATA:

26-07-2019

01 un Armário em MDF branco Iceland, 15mm com 4 portas e 6 nichos com as divisórias pintada na cor verde pastel. (Fig 06)

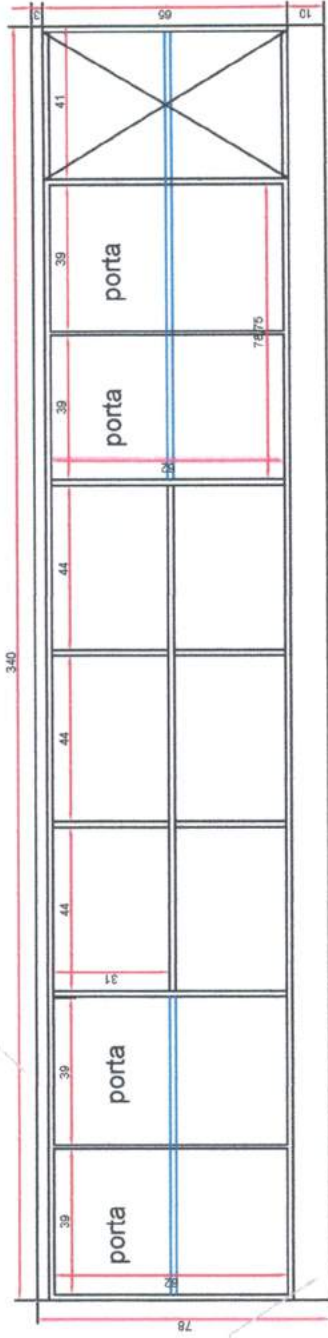

Rodapé em madeira de pinheiro revestido c/ fórmica branca TX

Vista Frontal

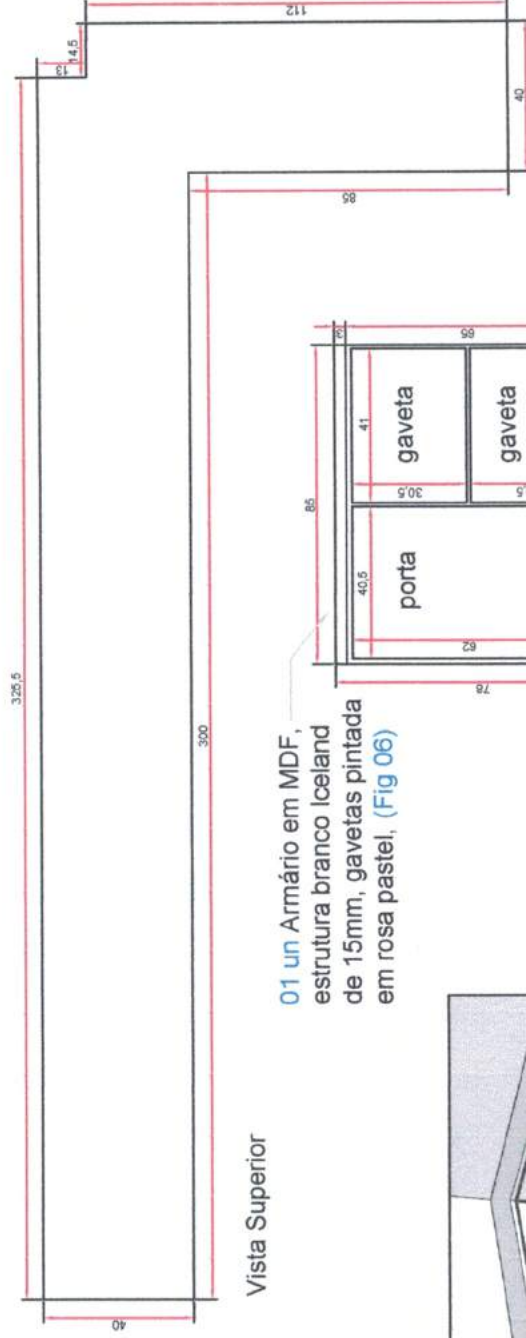

01 un Armário em MDF, estrutura branco Iceland de 15mm, gavetas pintada em rosa pastel, (Fig 06)

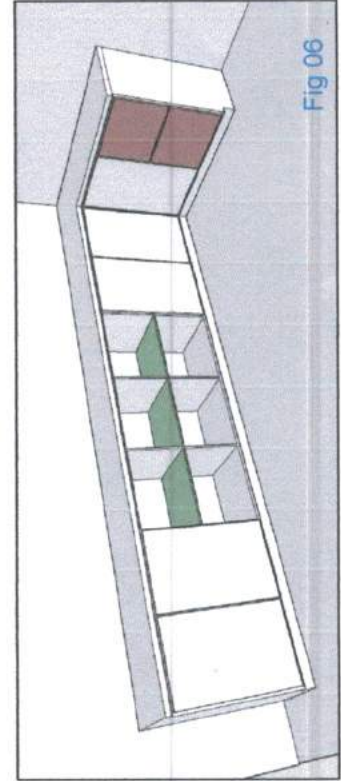

Fig 06

Rodapé em madeira de pinheiro revestido c/ fórmica branca TX

Vista Frontal

000071

ARQUITETO:

Arnildo Demuth Jr

CAU:

A 120850-0

CLIENTE:

CREAS

AMBIENTE:

Sala Multiuso

ESCALA:

1/20

DATA:

26-07-2019

01 un Armário aéreo com 1 porta em MDF Branco Iceland de 15mm, com prateleiras na lateral, porta em MDF de 15mm pintada na cor amarelo pastel. (Fig 07)

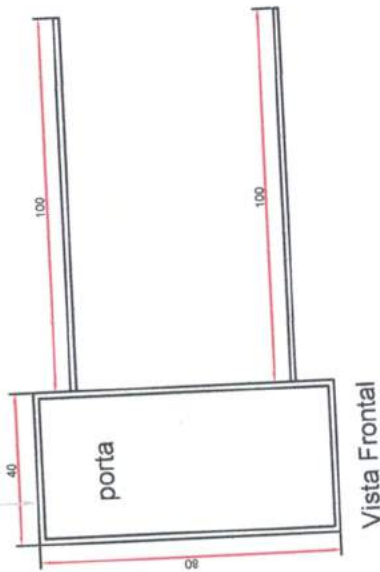

Vista Frontal

Vista Superior

Bancada em MDF branco Iceland de engrossado com 30mm (Fig 08)

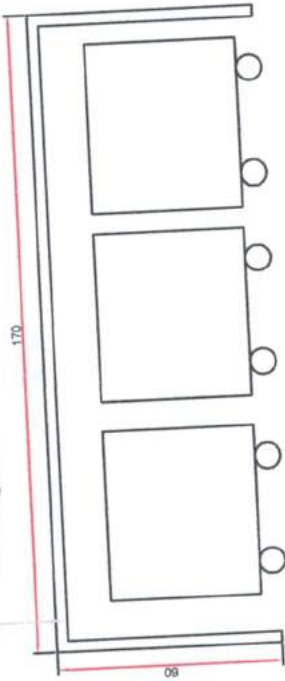

Vista Frontal

Vista Superior

03 un Caixa p/ brinquedos em MDF 15mm pintado e com rodízio de silicone 5 cm (1 azul pastel, 1 rosa pastel e 1 verde pastel) (Fig 08)

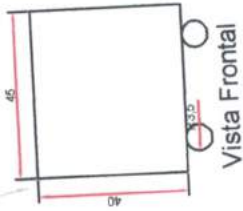

Vista Frontal

Vista Superior

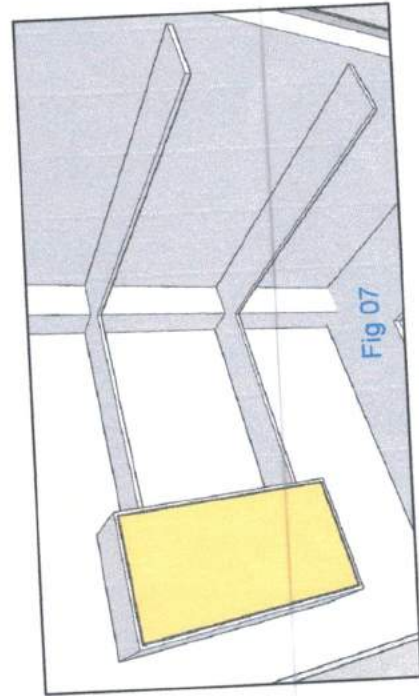

Fig 07

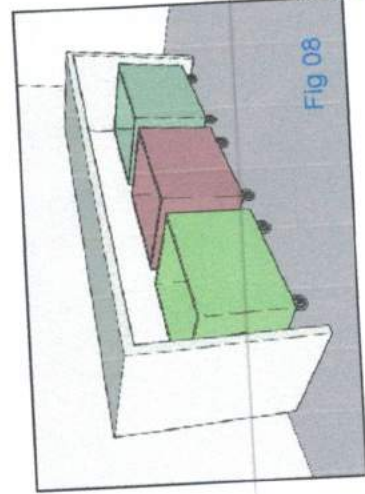
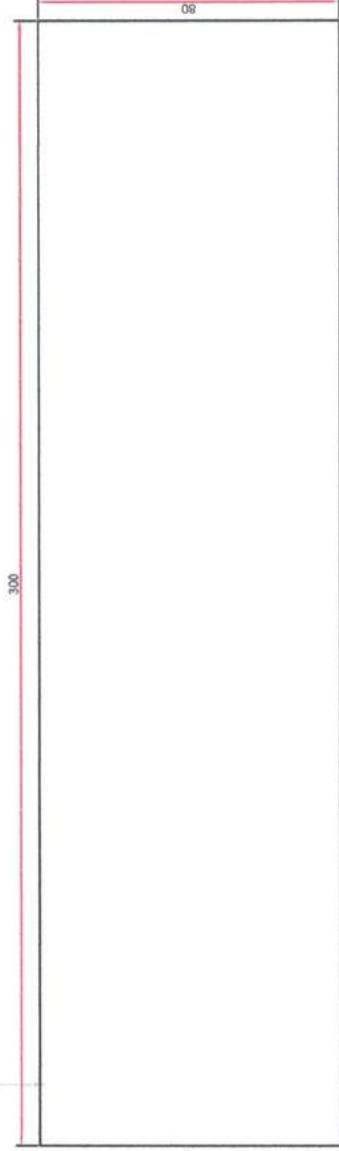

Fig 08

000072

01 un Tampo de mesa em MDF branco Iceland, engrossado com 30mm. (Fig 09)



Vista Superior

10 un Banqueta em madeira de pinheiro vernizada (Fig 09)

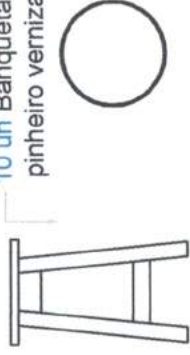

Vista Frontal

Vista Superior

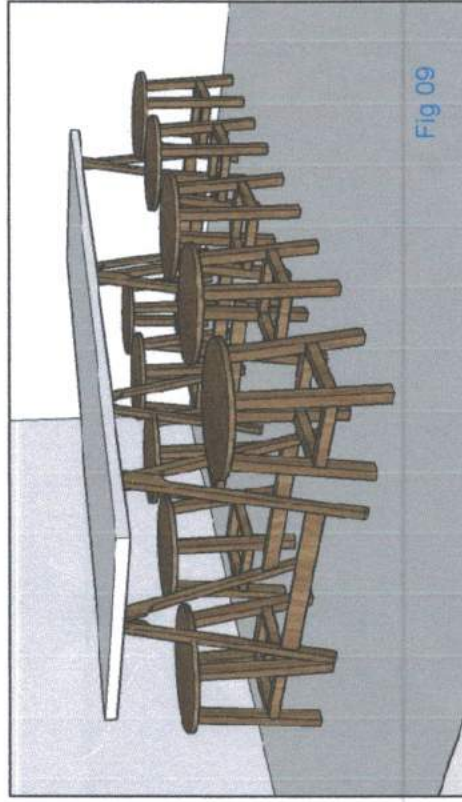
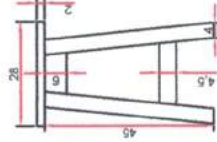
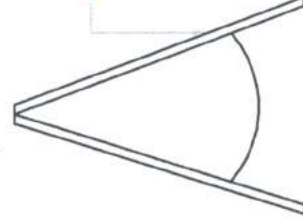
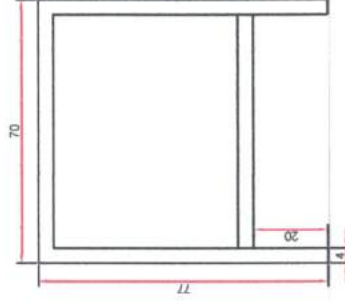

Fig 09

03 un Cavalete dobrável em madeira de pinheiro vernizada. (Fig 09)



Vista Lateral



Vista Frontal

000073

ARQUITETO:

Arnildo Demuth Jr

CAU:

A 120850-0

CLIENTE:

CREAS

AMBIENTE:

Sala Multiuso

ESCALA:

1/20

DATA:

26-07-2019

08 un Cadeira em madeira de pinheiro pintada (2 azul pastel, 2 amarela pastel, 2 rosa pastel e 2 verde pastel) (Fig 10)

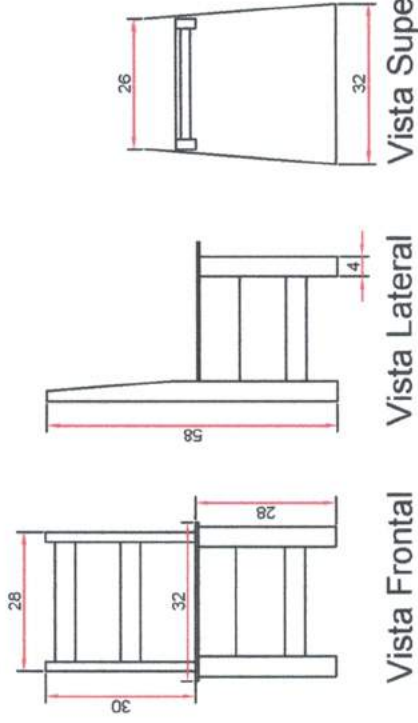

02 un Tampo mesa em MDF branco Iceland, 15mm (Fig 10)

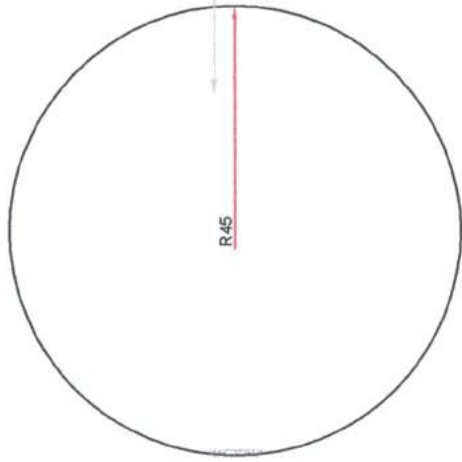

Vista Superior

02 un Pé para mesa em madeira de pinheiro pintada de branco (Fig 10)

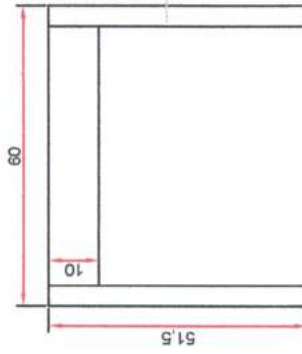

Vista Frontal

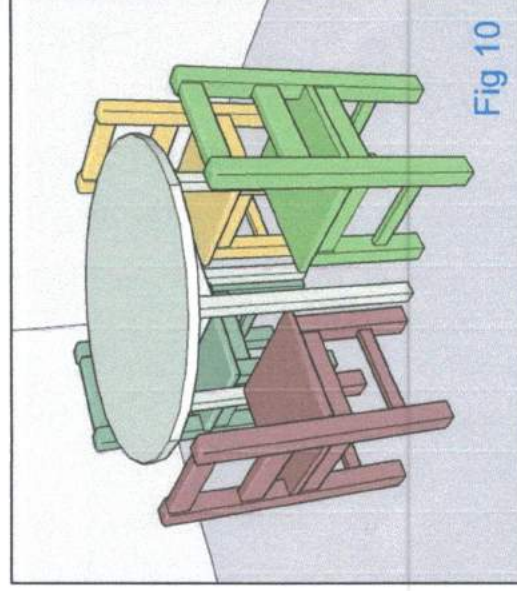
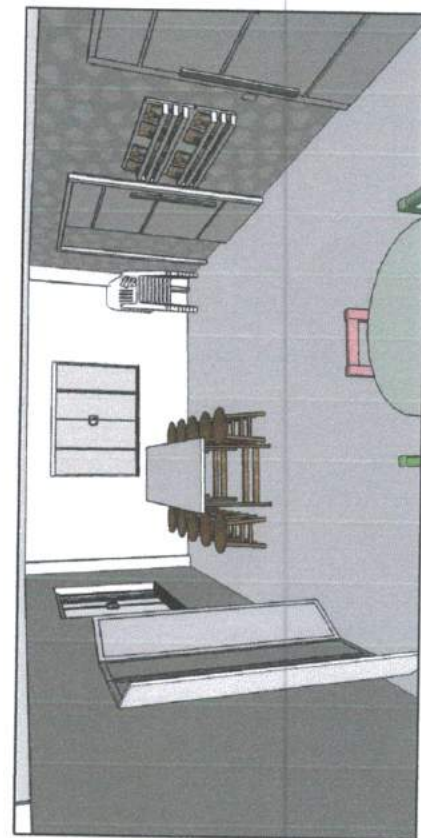
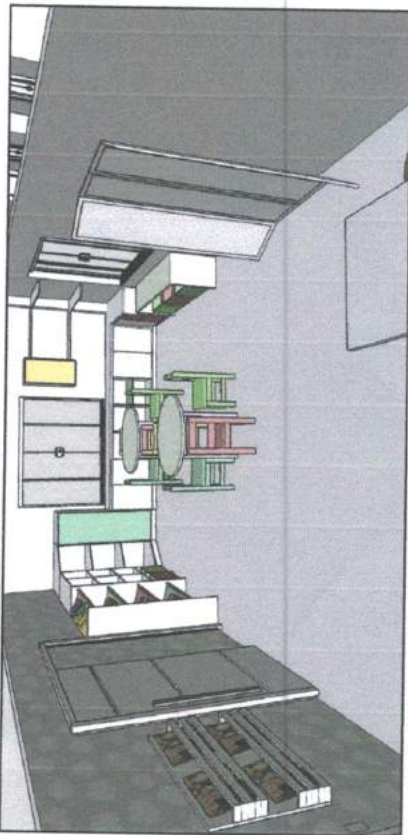
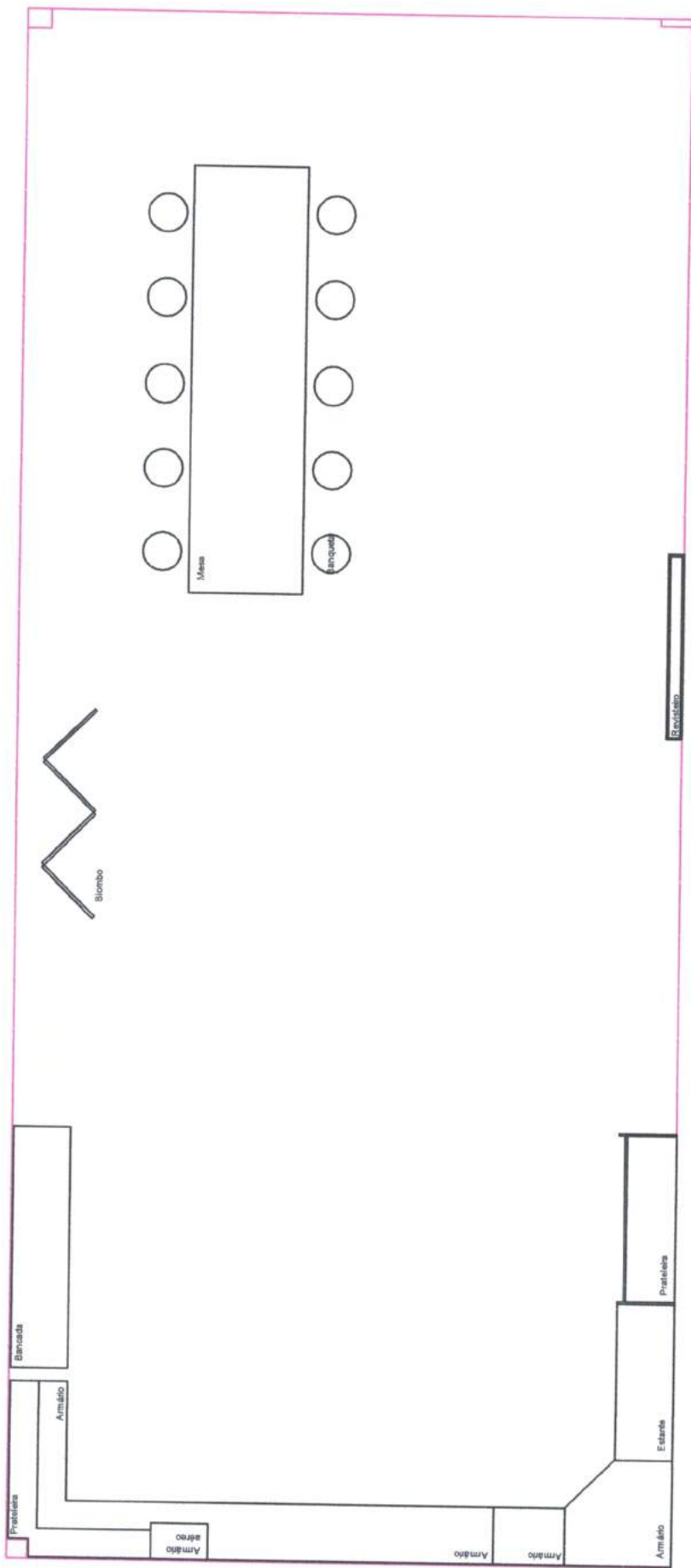

Fig 10

000074

ARQUITETO:	CAU:	CLIENTE:	AMBIENTE:	ESCALA:	DATA:
Arnildo Demuth Jr	A 120850-0	CREAS	Sala Multiuso	1/15	26-07-2019

000075



ARQUITETO:

Arnildo Demuth Jr

CAU:

A 120850-0

CLIENTE:

CREAS

AMBIENTE:

Sala Multiuso

ESCALA:

1/45

DATA:

26-07-2019

01 un Armário aéreo em MDF, estrutura Branco Iceland de 15mm, portas em MDF Nogal Champagne de 15mm. (FIG 01)

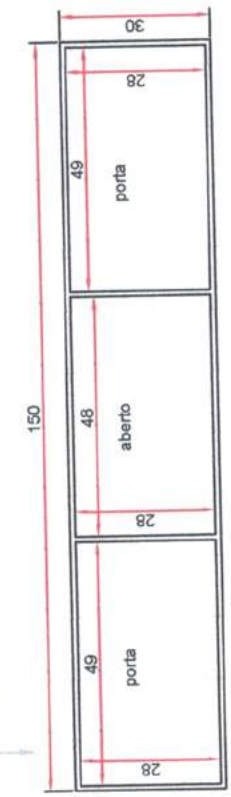

Vista frontal

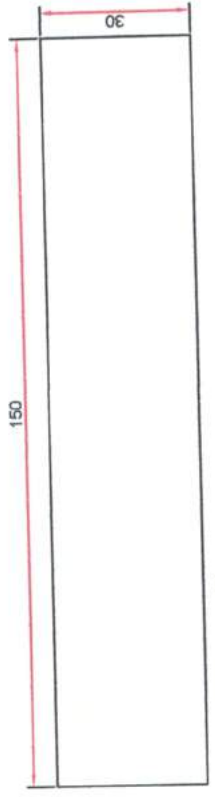

Vista superior

01 un Bancada em MDF Nogal Champagne engrossada com 30mm (FIG 01)

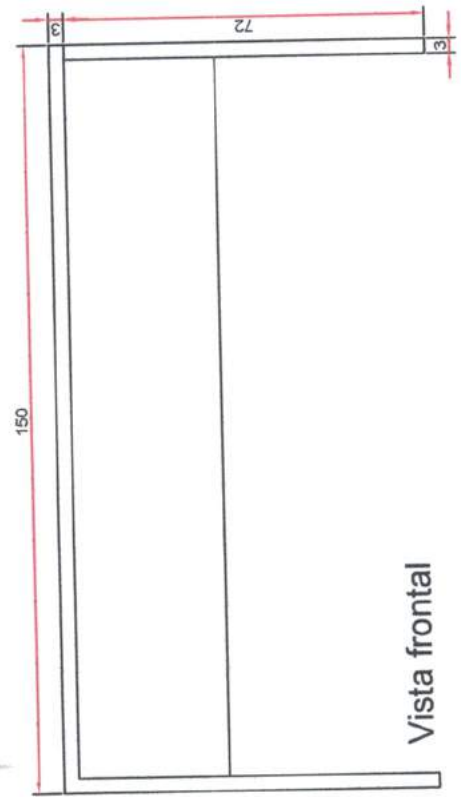

Vista frontal

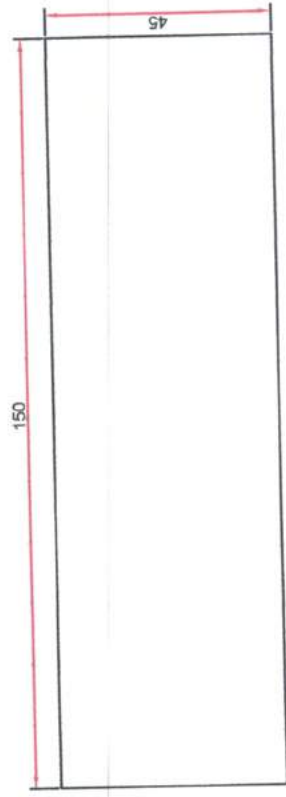
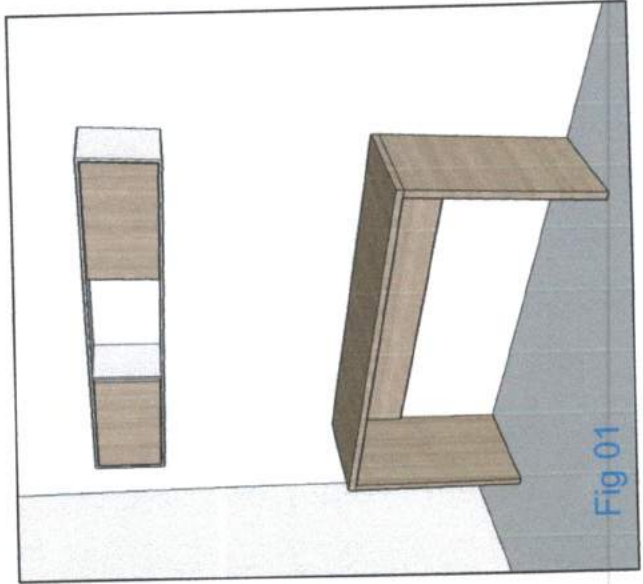

Vista superior

000076

ARQUITETO:	CAU:	CLIENTE:	ESCALA:	DATA:
Arnildo Demuth Jr	A 120850-0	CREAS	1/15	26-07-2019
AMBIENTE:			ESCALA:	
Adm. e Coordenação			1/15	

Painel em MDF Nogal Champagne
engrossado com 45mm, com friso (FIG 02)

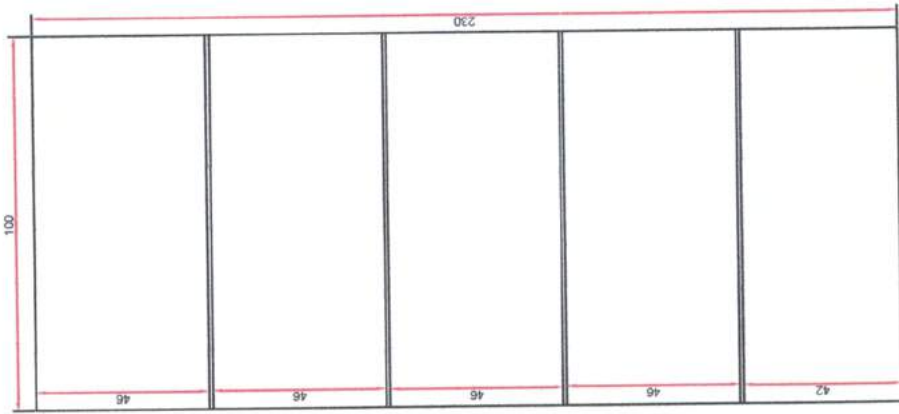

Vista frontal

Mesa em MDF Nogal Champagne
engrossada com 30mm (FIG 02)

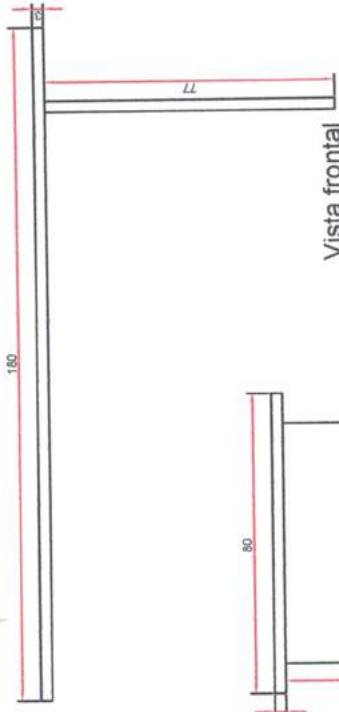

Vista frontal

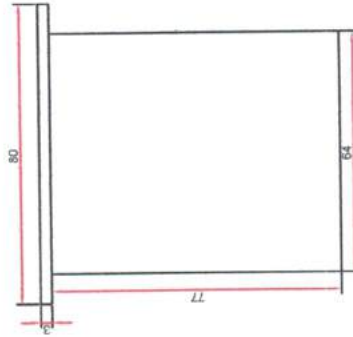

Vista lateral

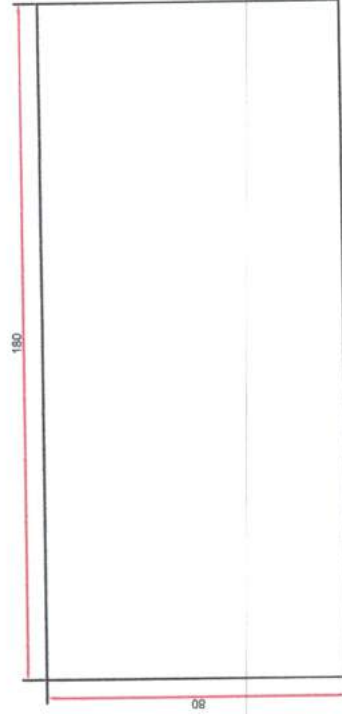

Vista superior

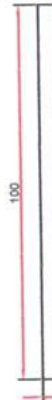

Vista superior

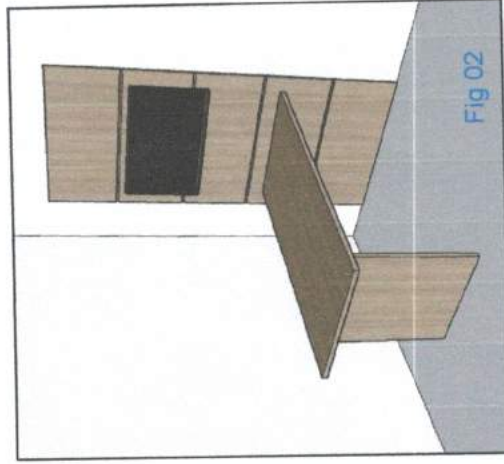

Fig 02

000077

ARQUITETO:

Arnildo Demuth Jr

CAU:

A 120850-0

CLIENTE:

CREAS

AMBIENTE:

Adm. e Coordenação

ESCALA:

1/20

DATA:

26-07-2019

01 un Armário aéreo em MDF, estrutura Branco Iceland de 15mm, portas em MDF Nogal Champagne de 15 mm. (FIG 03)

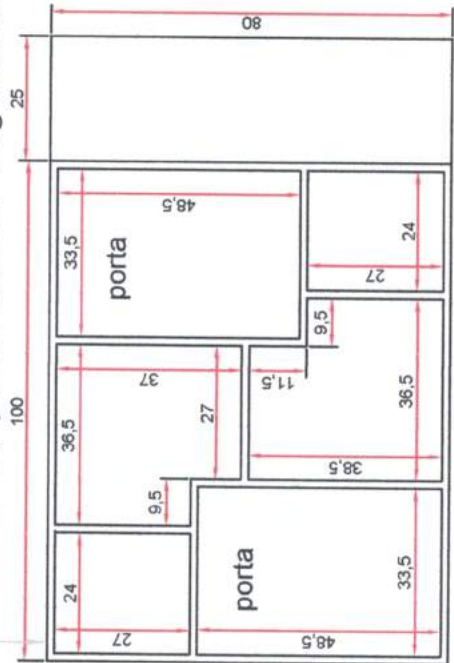

Vista frontal

01 un Armário aéreo em MDF, estrutura Branco Iceland de 15mm portas e prateleiras em MDF Nogal Champagne de 15mm. (FIG 03)

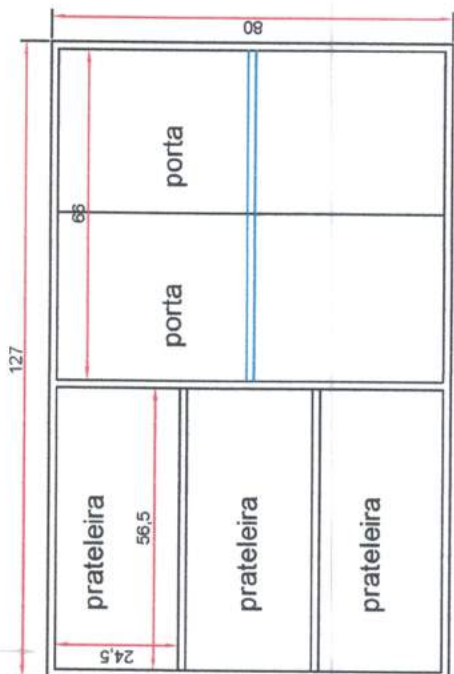

Vista frontal

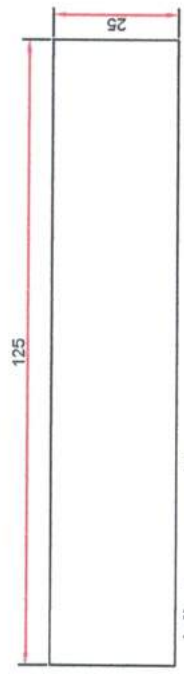

Vista superior

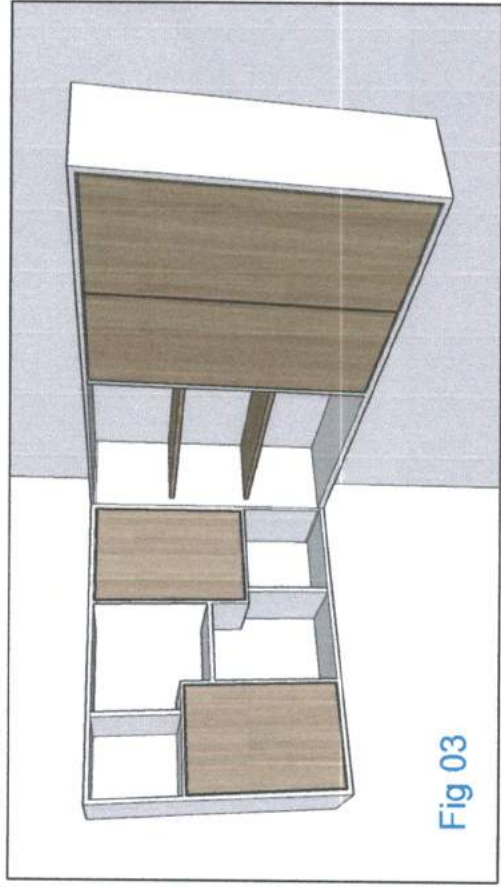
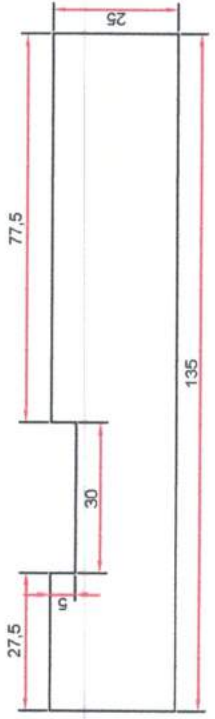

Fig 03



Vista superior

000078

ARQUITETO:	CAU:	CLIENTE:	AMBIENTE:	ESCALA:	DATA:
Arnildo Demuth Jr	A 120850-0	CREAS	Adm. e Coordenação	1/15	26-07-2019

01 un Armário em MDF, estrutura Branco Iceland de 15mm, portas em MDF Nogal Champagne de 15mm. (FIG 04)

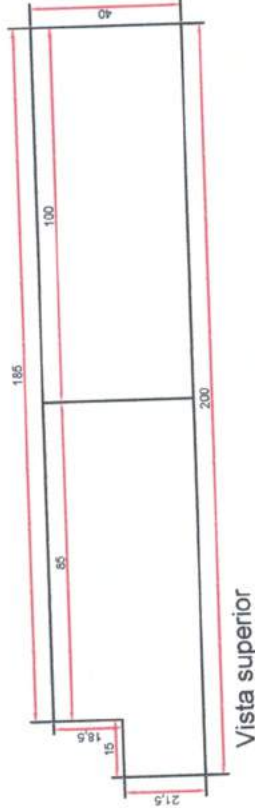

Vista superior

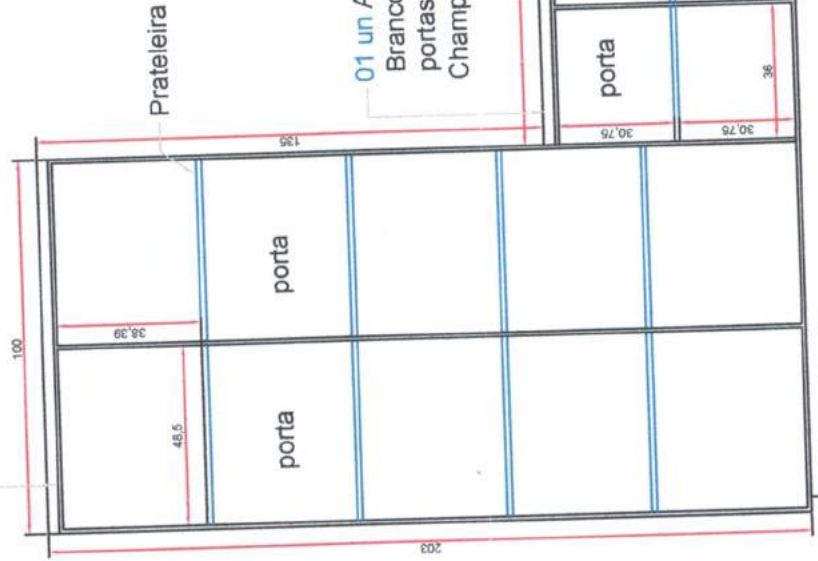

Vista frontal

01 un Armário em MDF, estrutura Branco Iceland de 15mm, tampo, portas e cantoneira em MDF Nogal Champagne de 15mm. (FIG 04)

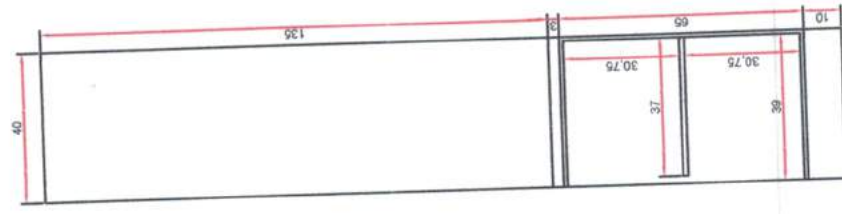

Vista lateral

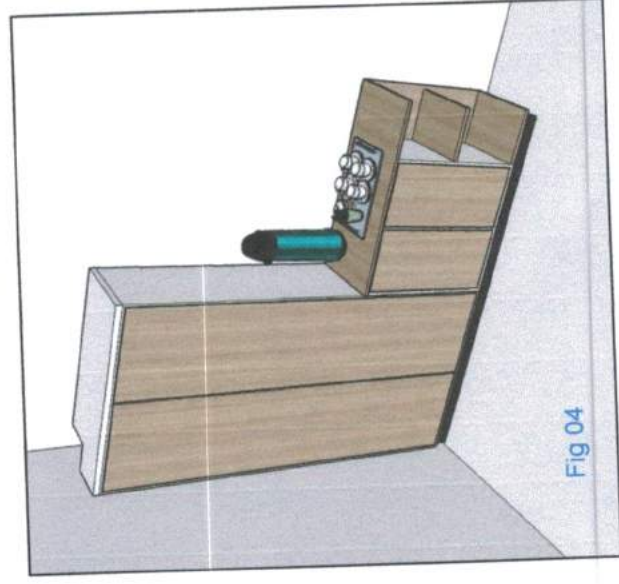
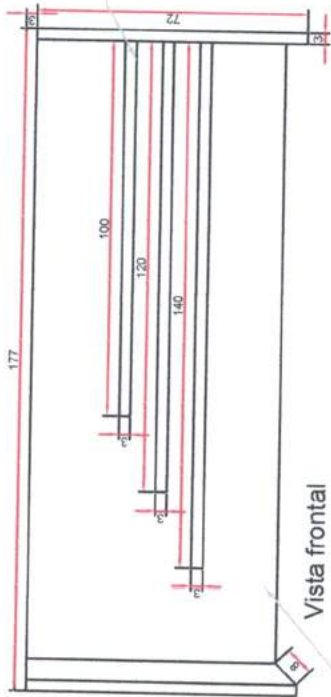

Fig 04

Rodapé em madeira de pinheiro revestido c/ fórmica preta TX

000079



Vista frontal

01 un Escrivaninha formato em L,
com 4 gavetas em MDF Nogal
Champagne engrossado
com 30mm. (FIG 05)



Escrivaninha vista
interna (FIG 06)

Rodapé em
madeira de
pinheiro
revestido
c/ fórmica
preta TX

Vista frontal
interna

Detalhe em MDF Branco
lceland de 15mm, medindo
3x5 (AxP)

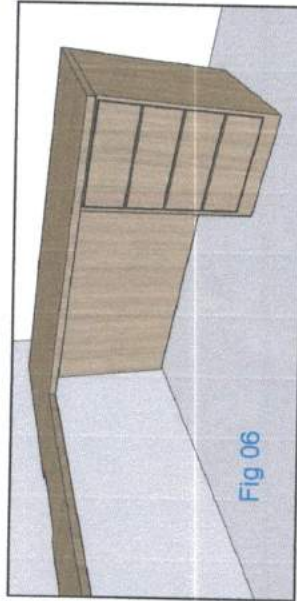

Fig 06

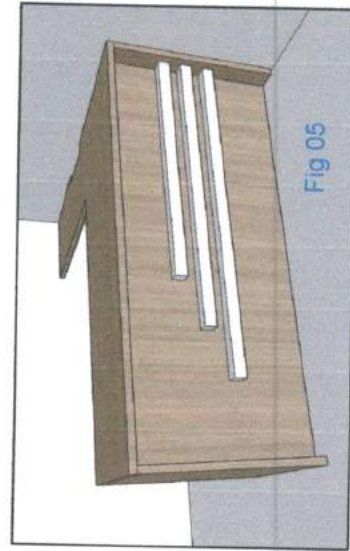
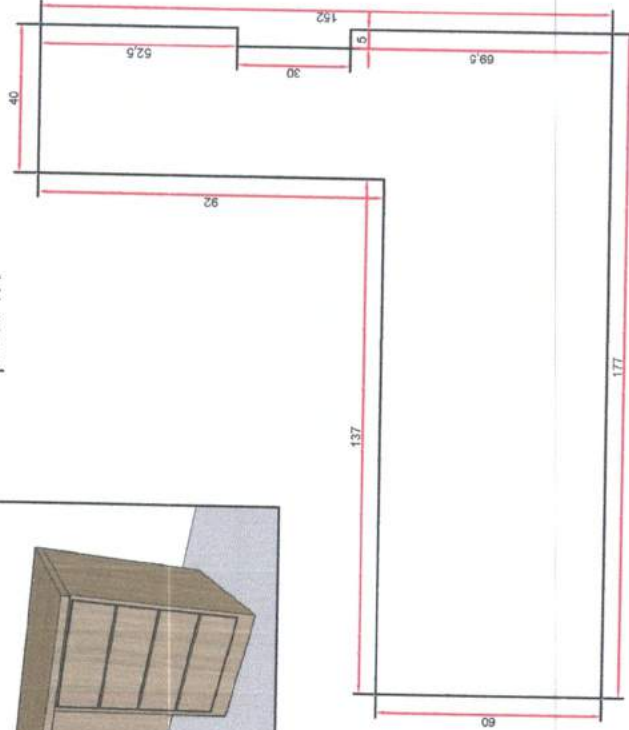

Fig 05



Vista superior

000080

ARQUITETO:

Arnildo Demuth Jr

CAU:

A 120850-0

CLIENTE:

CREAS

AMBIENTE:

Adm. e Coordenação

ESCALA:

1/20

DATA:

26-07-2019

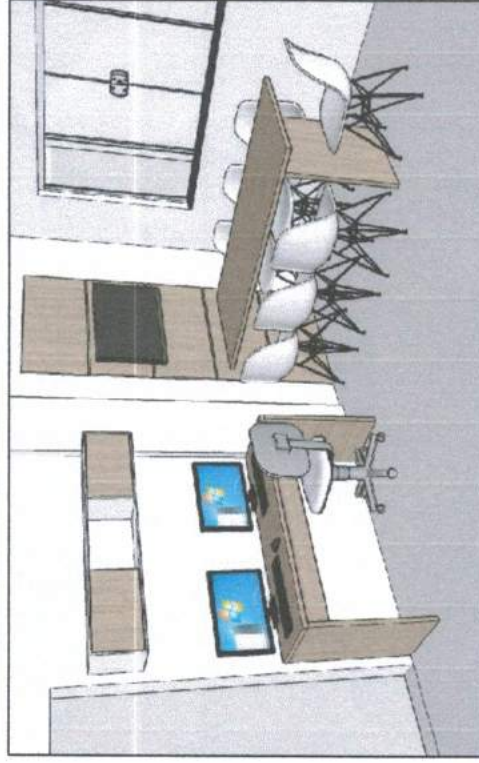
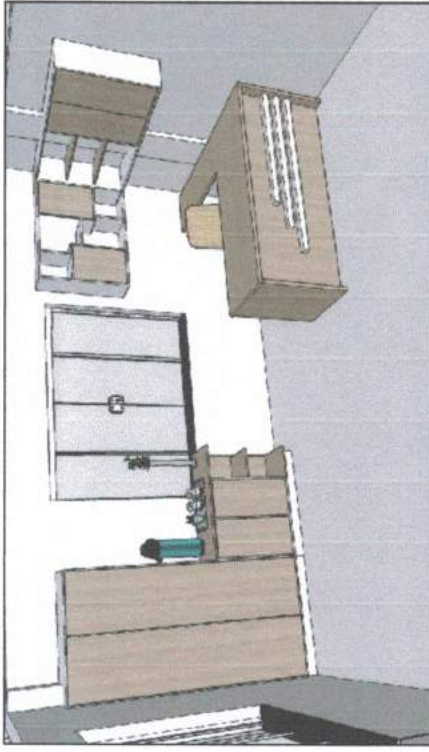
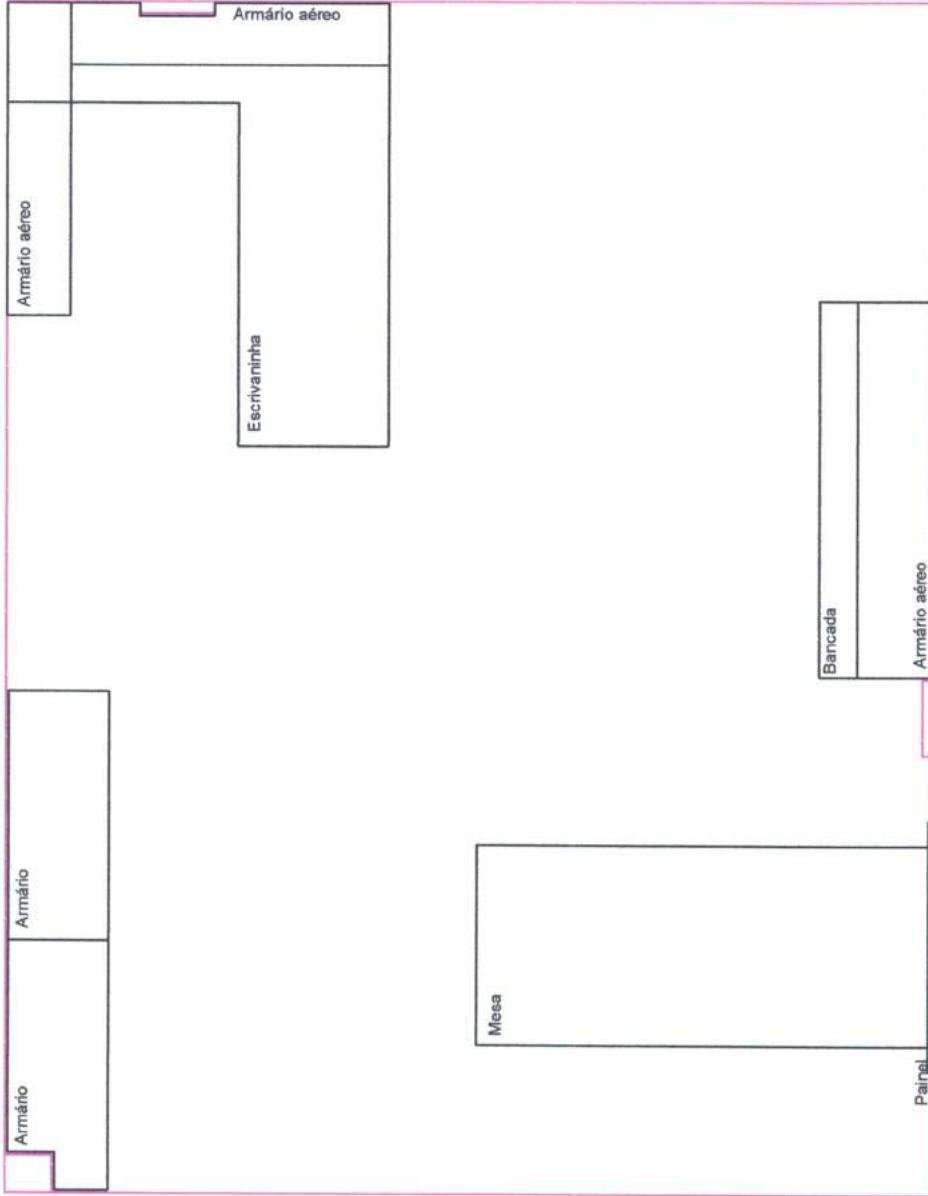

000081

ARQUITETO:

Arnildo Demuth Jr

CAU:

A 120850-0 CREAS

CLIENTE:

Adm. e Coordenação

AMBIENTE:

ESCALA:

1/30

DATA:

26-07-2019

01 un Armário em MDF, estrutura Nogal Champagne de 15mm, com prateleiras e nicho na lateral, portas em MDF Cafelatte de 15mm. (FIG 01)

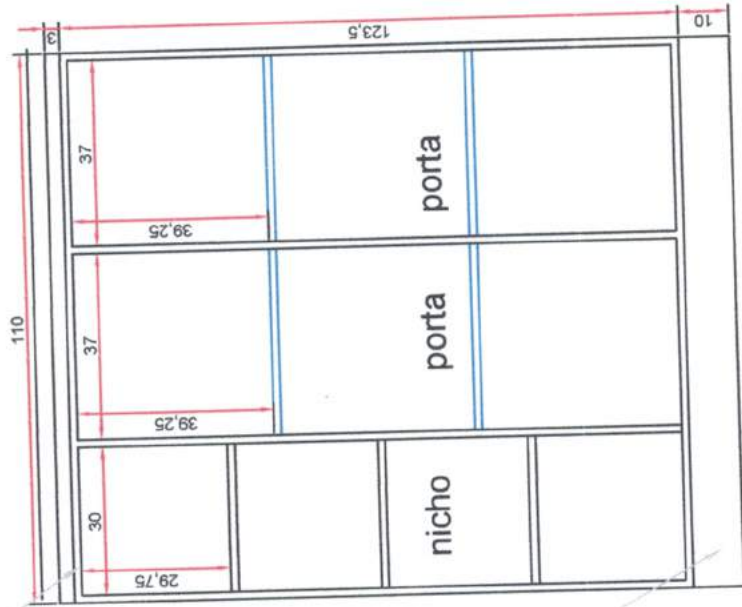

Rodapé em madeira de pinheiro revestido c/ fórmica preta TX

Vista frontal

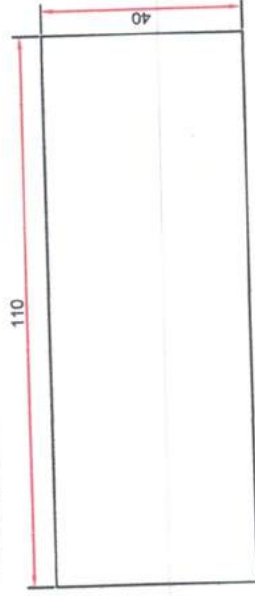

Vista superior

01 un Aparador em MDF Nogal Champagne engrossado para 30mm (FIG 02)

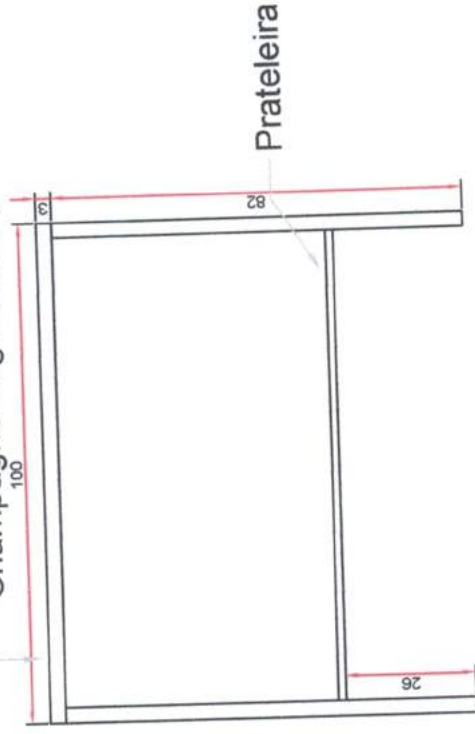

Vista frontal

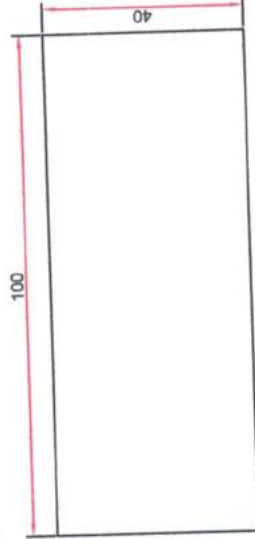

Vista superior

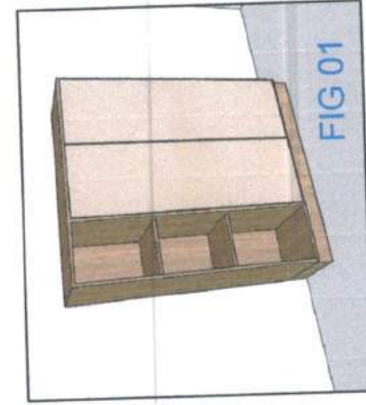

FIG 01

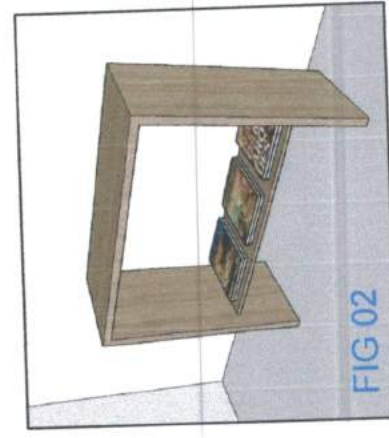
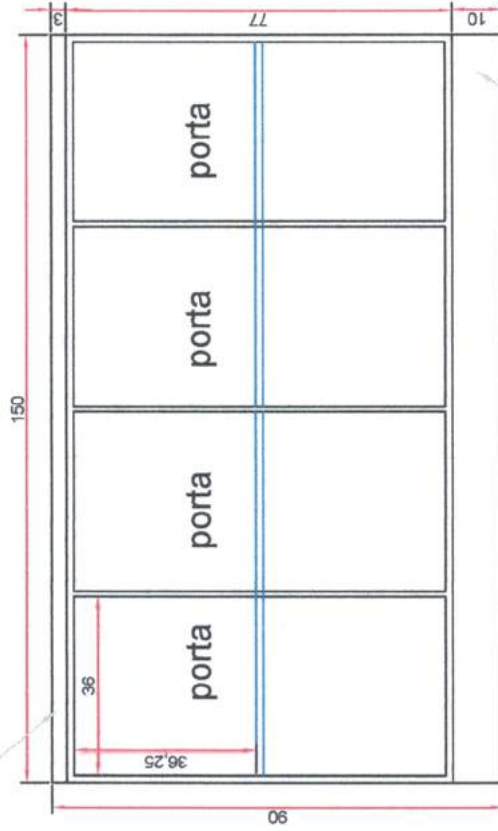

FIG 02

000082

01 un Armário em MDF, estrutura Nogal Champagne de 15mm, com prateleira, portas em MDF Cafelatte de 15mm. (FIG 03)



Vista frontal

Rodapé em madeira de pinheiro revestido c/ fórmica preta TX

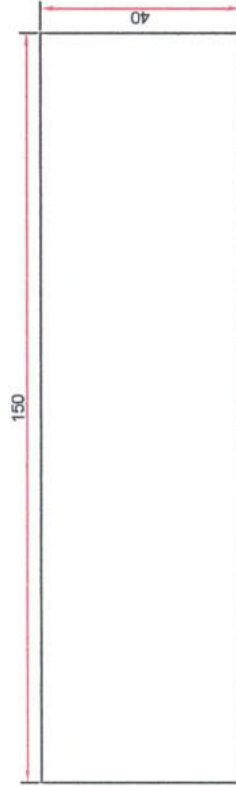

Vista superior

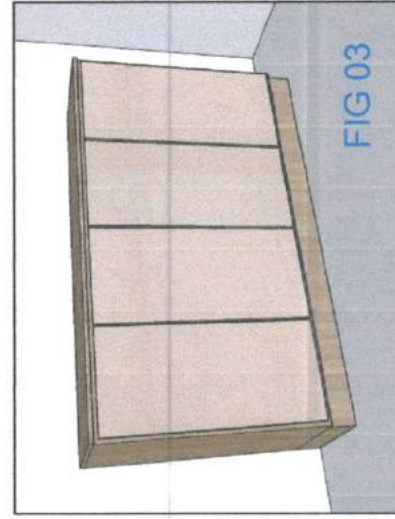
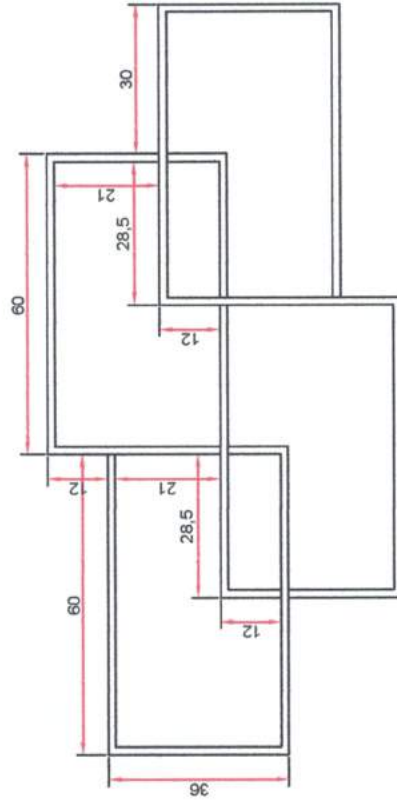
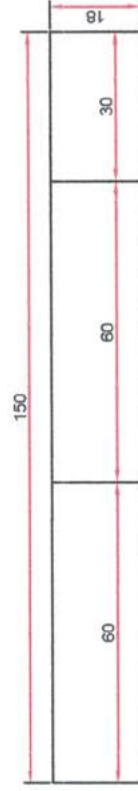

FIG 03

01 un Nicho em MDF Cafelatte de 15mm, com fundo (FIG 04)



Vista frontal



Vista superior

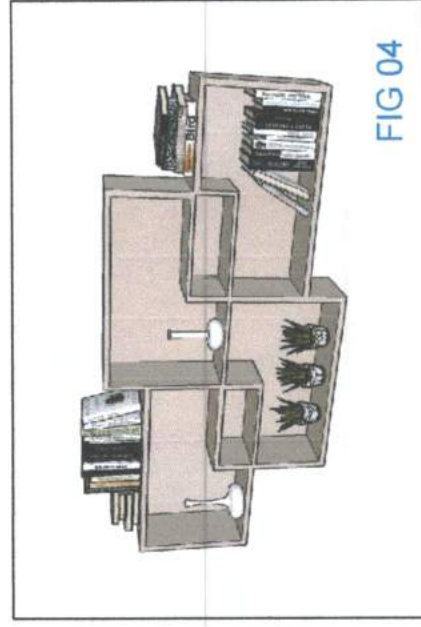
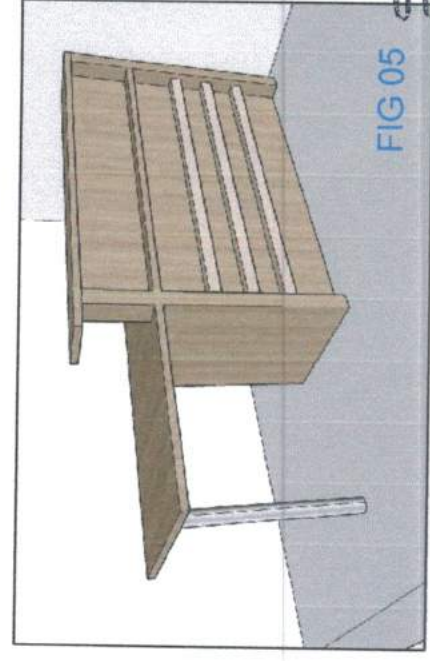
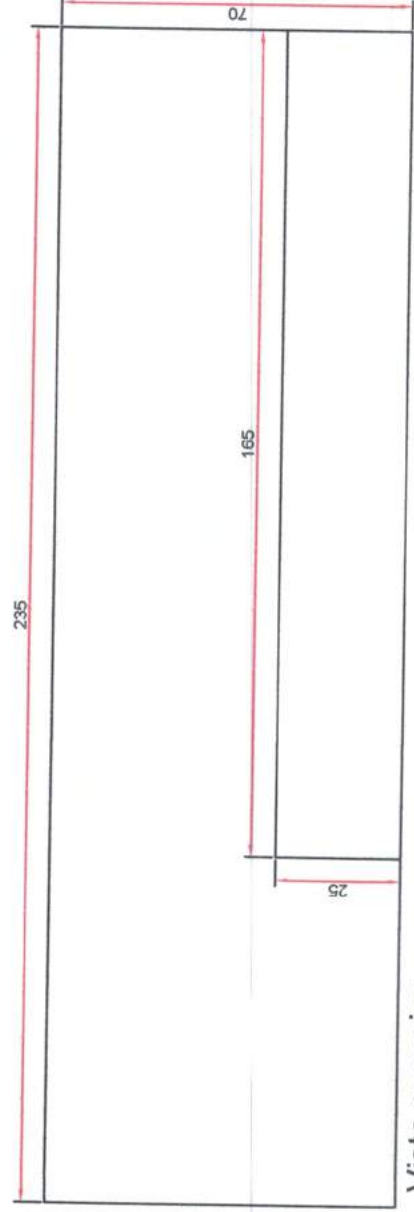
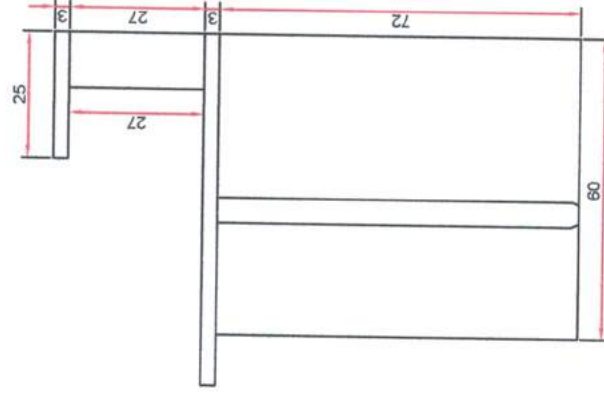
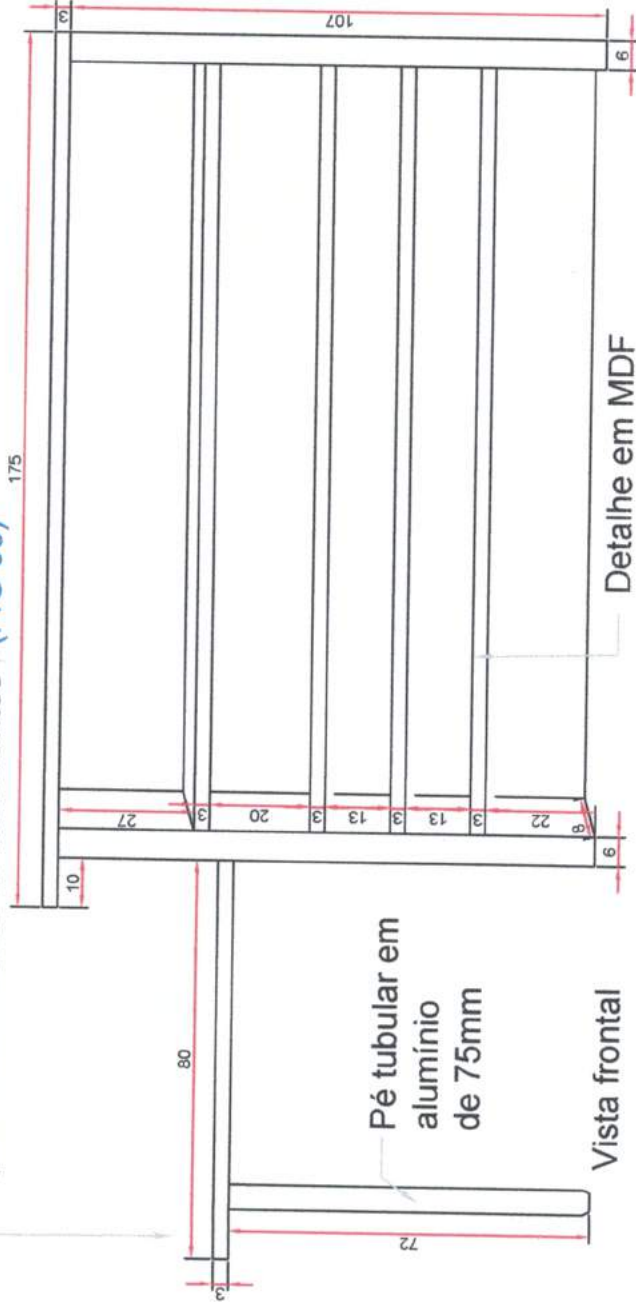

FIG 04

000083

01 un Balcão de atendimento em MDF Nogal
 Champagne de 15mm com bancada exclusiva
 para atendimento de cadeirantes (FIG 05)



000084

01 un Mural com isopor de 18mm, tecido, moldura em MDF Cafelatte. (FIG 07)

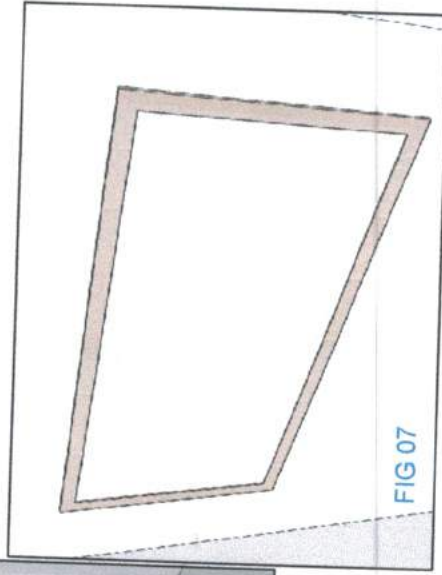
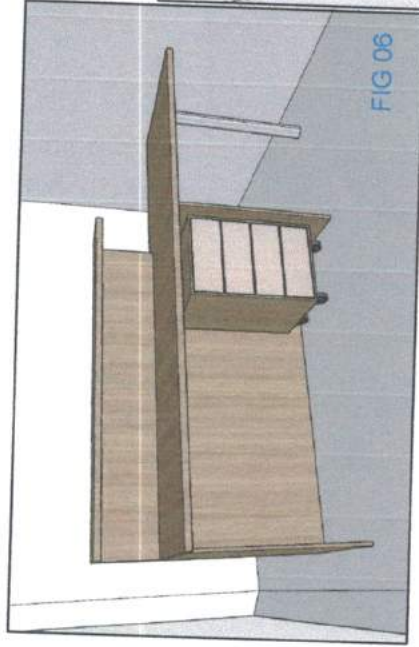
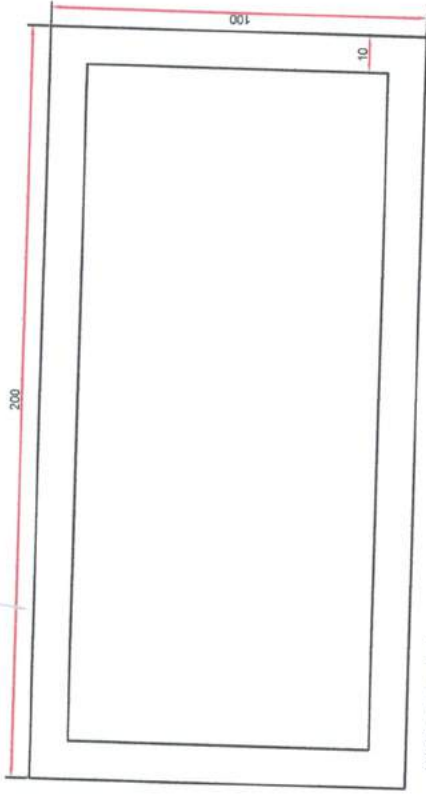

Balcão de atendimento (FIG 06)

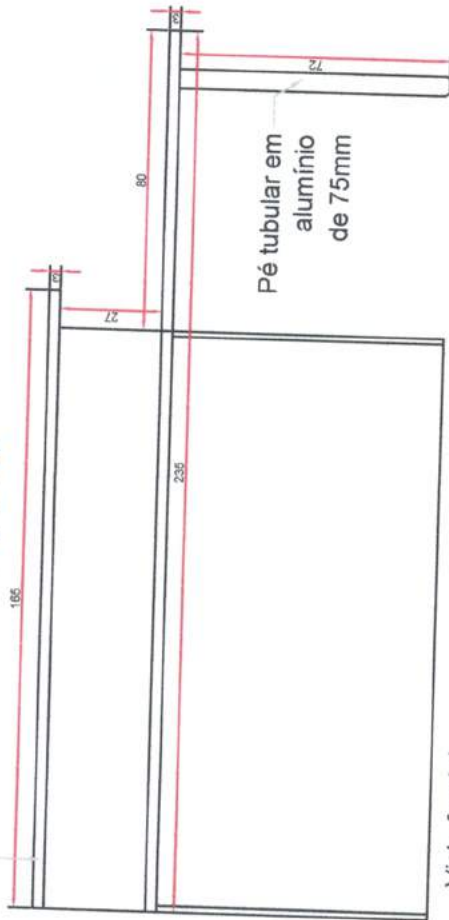

01 un Gaveteiro em MDF Nugal Champagne de 15mm com 4 gavetas com rodízios de silicone de 5 cm, frente de gavetas em MDF Cafelatte de 15mm. (FIG 06)

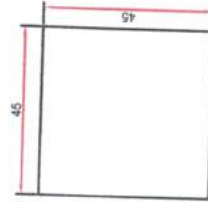
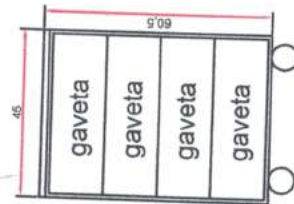

000008

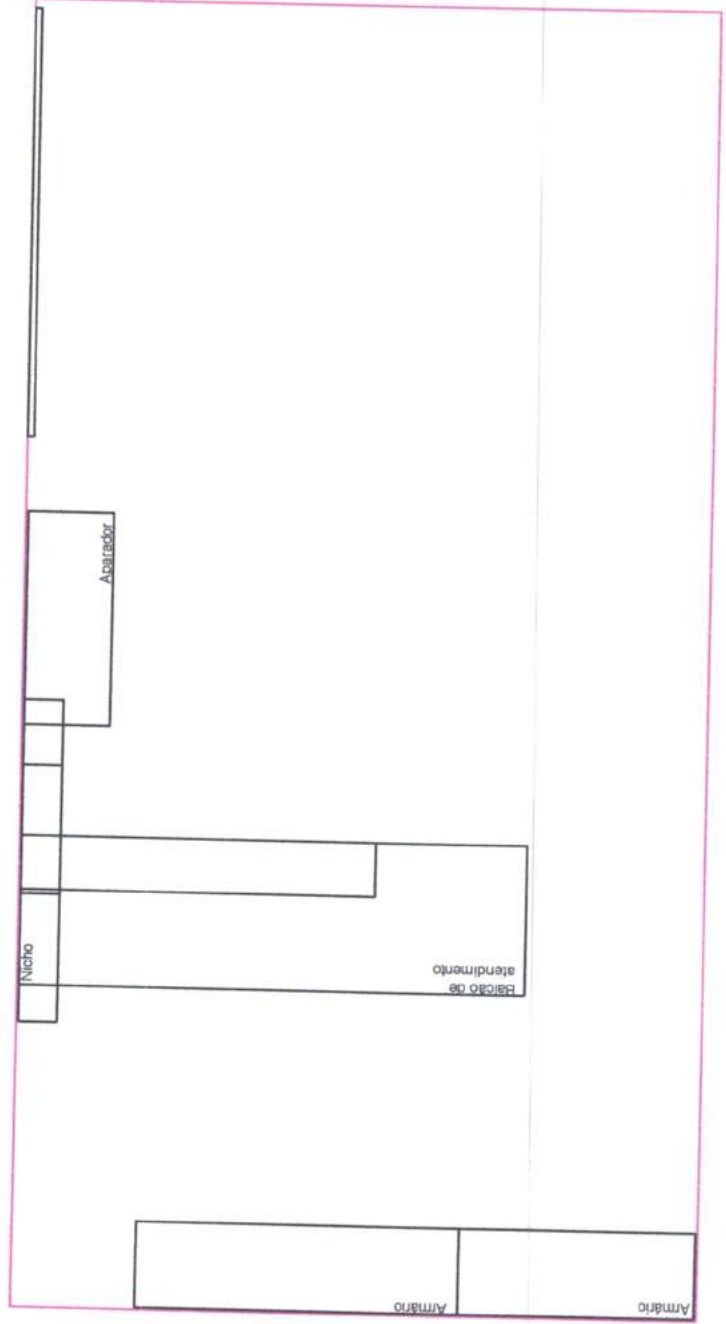
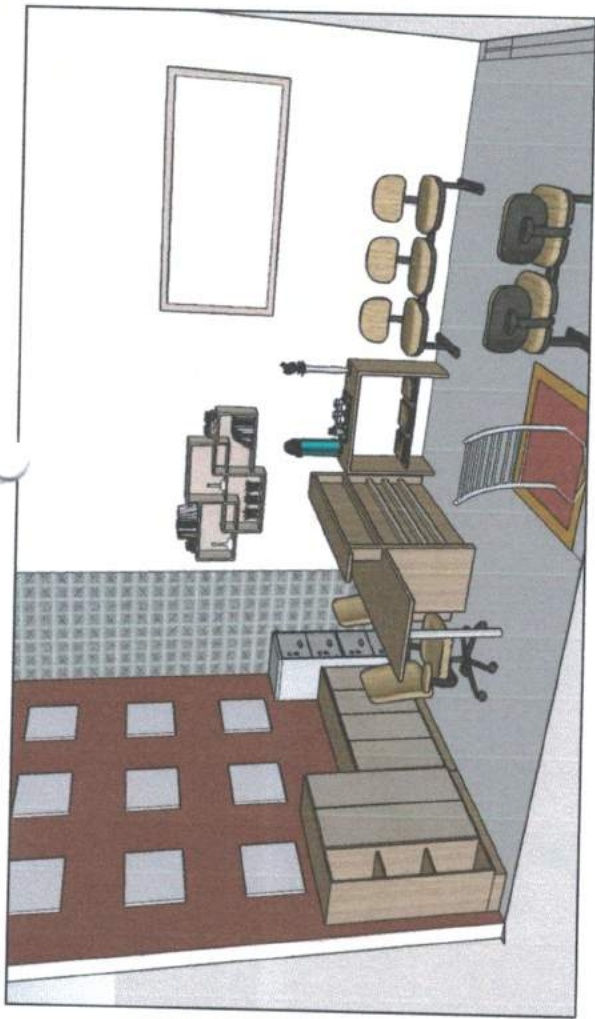

000086

ARQUITETO: Arnildo Demuth Jr	CAU: A 120850-0	CLIENTE: CREAS	AMBIENTE: Recepção	ESCALA: 1/35	DATA: 26-07-2019
--	---------------------------	--------------------------	------------------------------	------------------------	----------------------------

01 un Escrivaninha formato em L, com 4 gavetas em MDF Nogal Champagne engrossado com 30mm, frente de gaveta em MDF Branco Iceland de 15mm, (FIG 01)

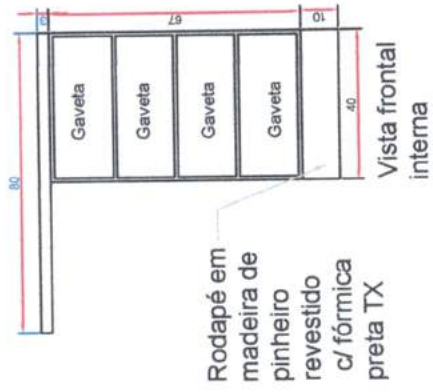
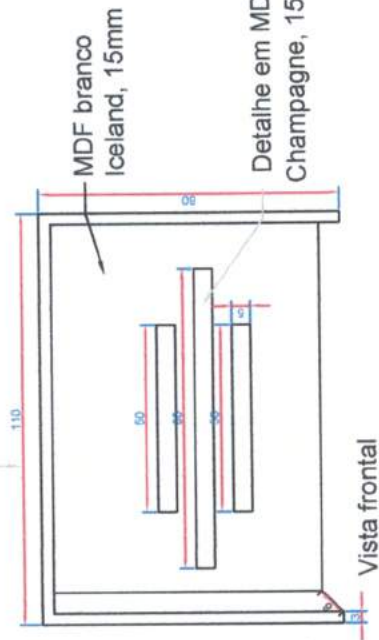

02 un Nicho em MDF Branco Iceland de 15mm (Fig. 01)

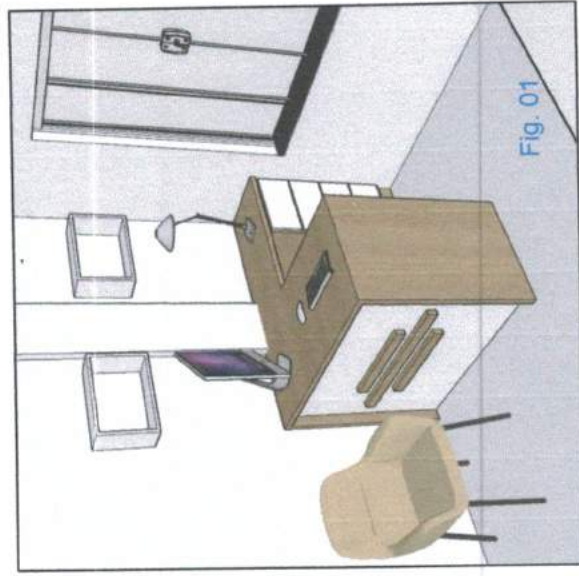
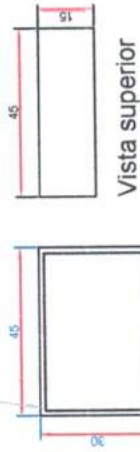
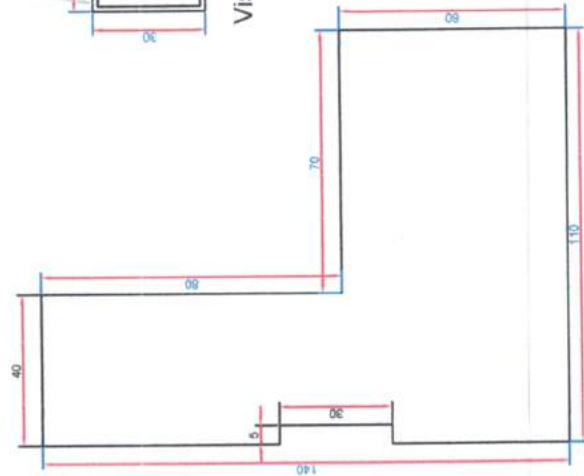

000087

ARQUITETO:

Arnildo Demuth Jr

CAU:

A 120850-0

CLIENTE:

CREAS

AMBIENTE:

Atend. Familiar 01

ESCALA:

1/20

DATA:

26-07-2019

01 un Armário em MDF, estrutura Nogal Champagne de 15mm, com prateleiras, portas em MDF Branco Iceland, de 15mm (FIG 02)

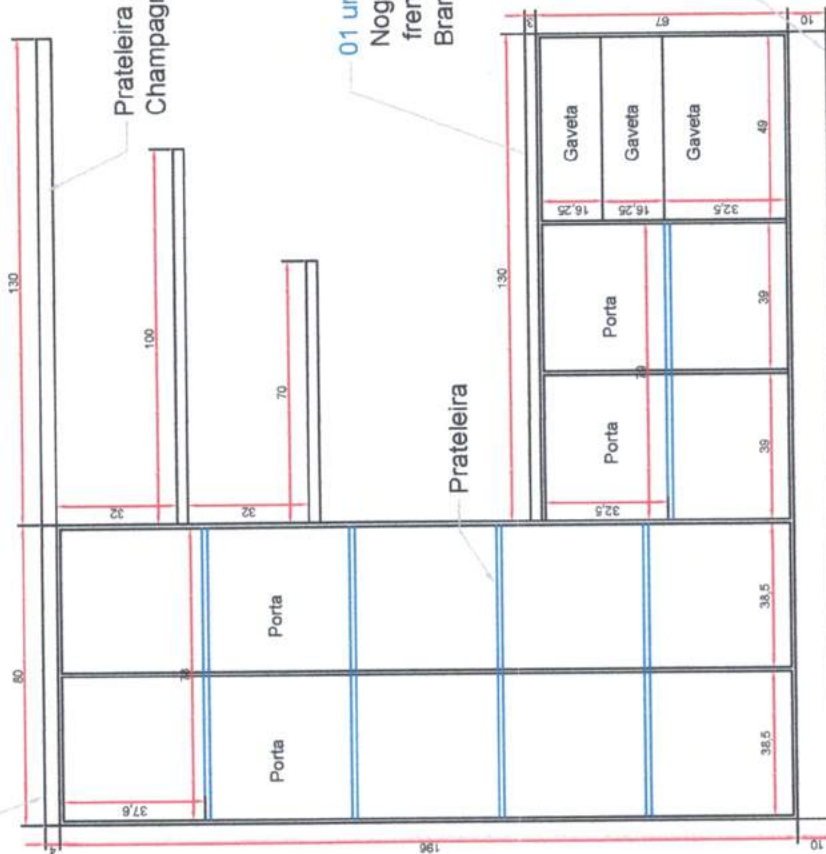

Vista frontal

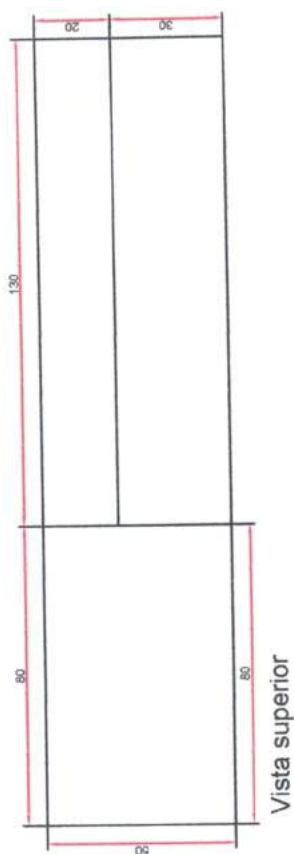

Vista superior

01 un Armário em MDF, estrutura Nogal Champagne de 15mm, frente de gavetas e portas em MDF Branco Iceland de 15mm (FIG 02)

Rodapé em madeira de pinheiro revestido c/ fórmica preta TX

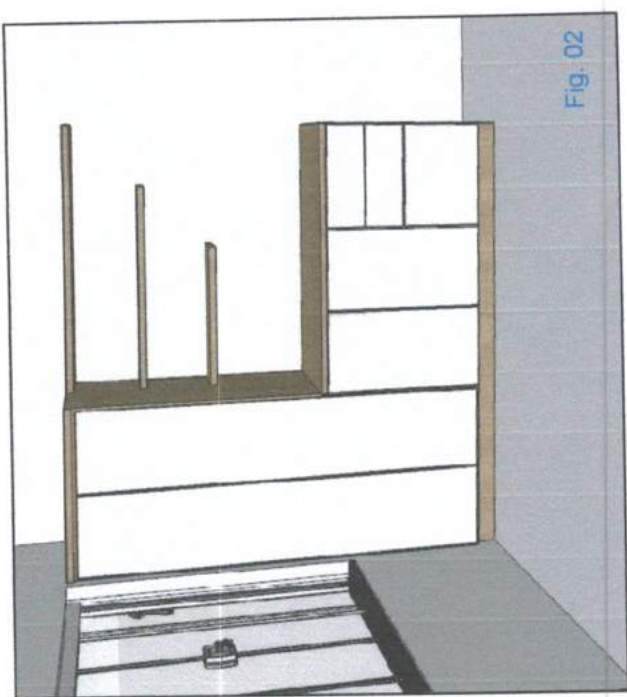

000088

000089

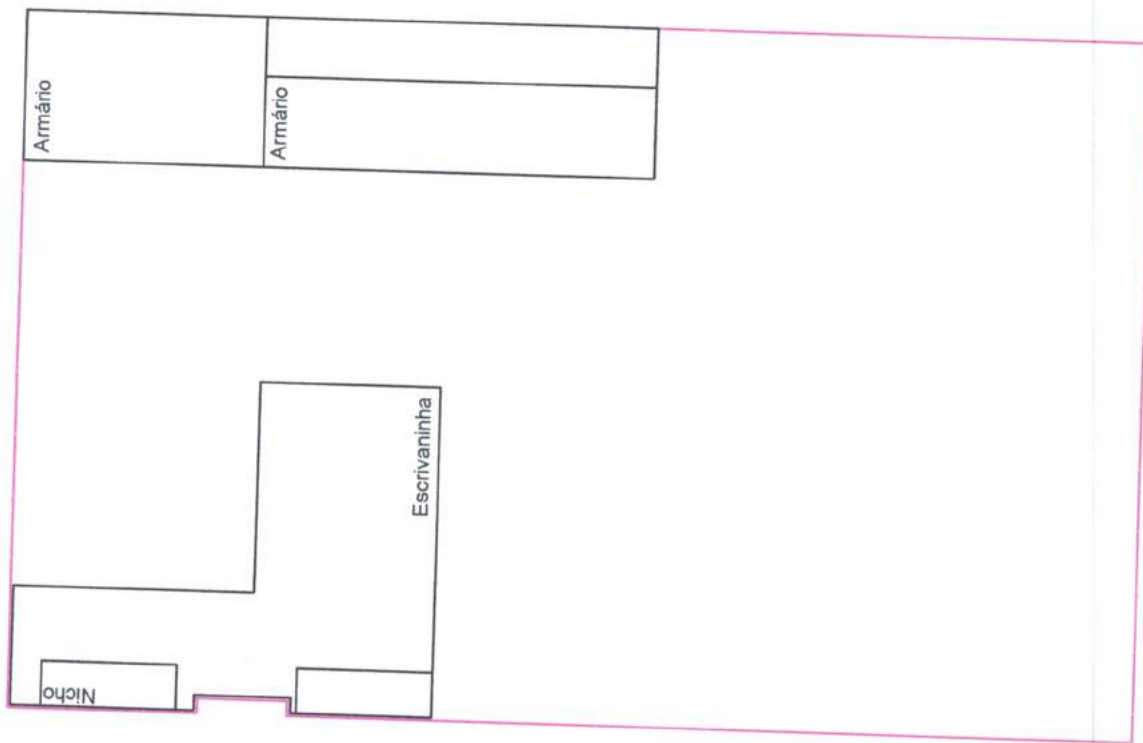
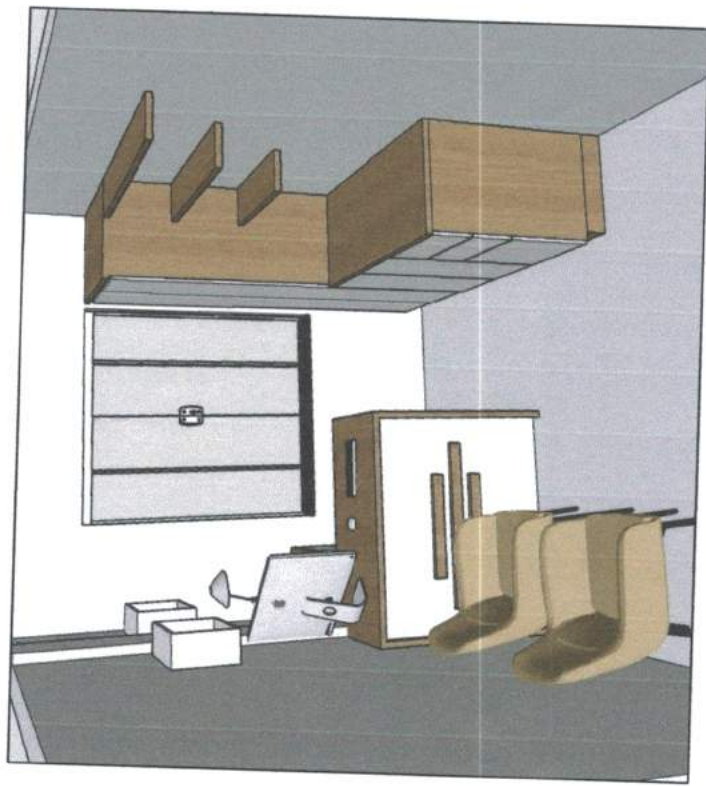

ARQUITETO:

Arnildo Demuth Jr

CAU:

A 120850-0

CLIENTE:

CREAS

AMBIENTE:

Atend. Familiar 01

ESCALA:

1/25

DATA:

26-07-2019

01 un Escrivaninha formato em L, com 4 gavetas, estrutura em MDF Nogal Champagne, 15mm, frente de gaveta em MDF Branco Iceland de 15mm, (FIG 01)

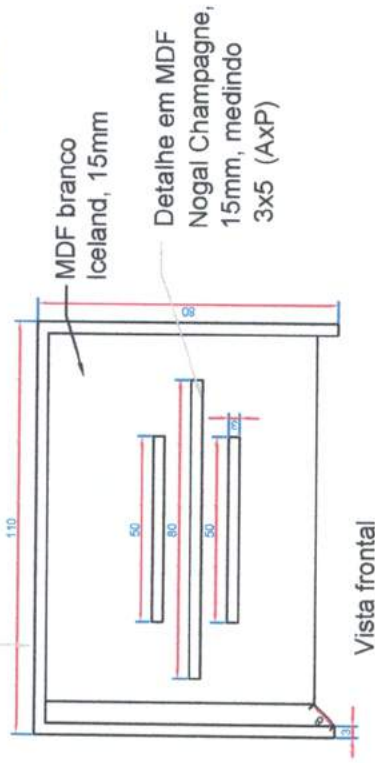

Vista frontal

03un Nicho em MDF Branco Iceland, 15mm, com fundo. (Fig.01)

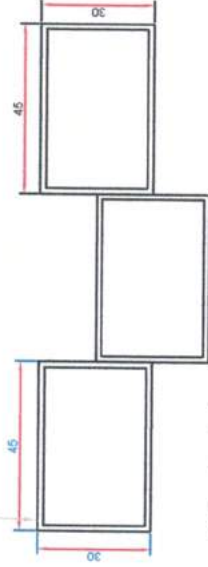

Vista frontal

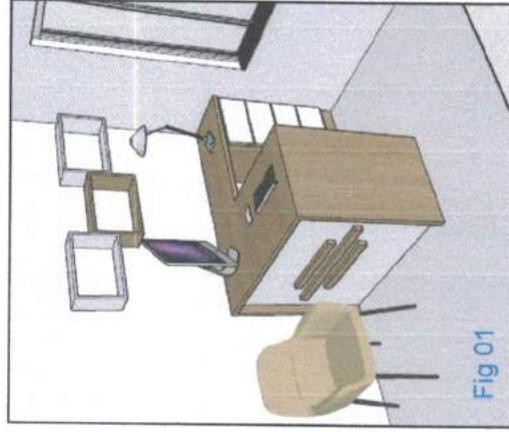

Rodapé em madeira de pinheiro revestido c/ fórmica preta TX

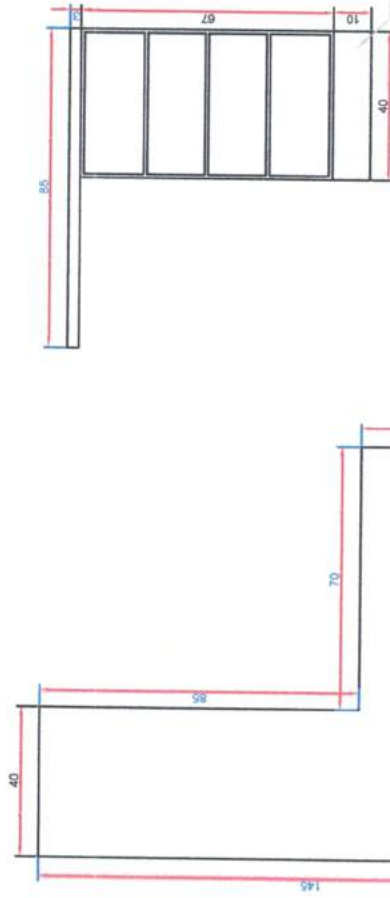

Vista frontal interna

Vista superior

000090

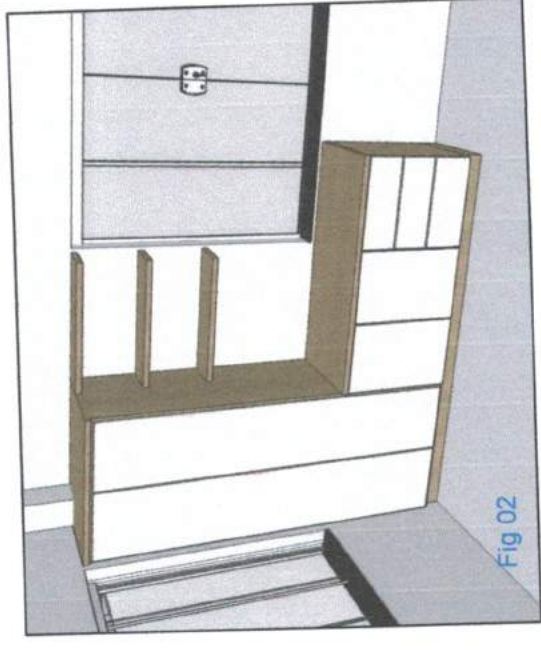

01 un Armário em MDF, estrutura Nogueira Champagne de 15mm, com prateleiras, portas em MDF Branco Iceland, de 15mm (FIG 02)



Vista frontal

Prateleira em MDF Nogueira Champagne de 15mm

01 un Armário em MDF, estrutura Nogueira Champagne de 15mm, frente de gavetas e portas em MDF Branco Iceland de 15mm (FIG 02)

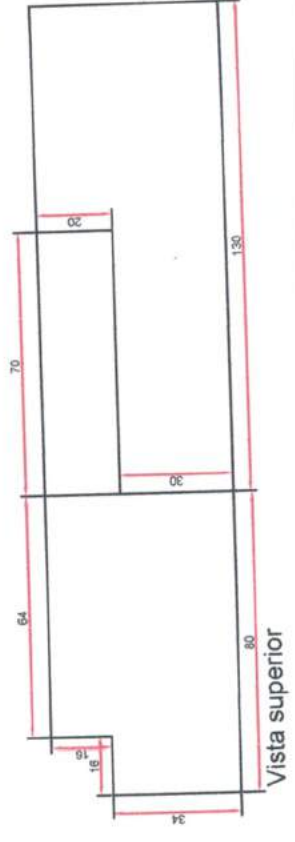

Vista superior

Rodapé em madeira de pinheiro revestido c/ fórmica preta TX

000091

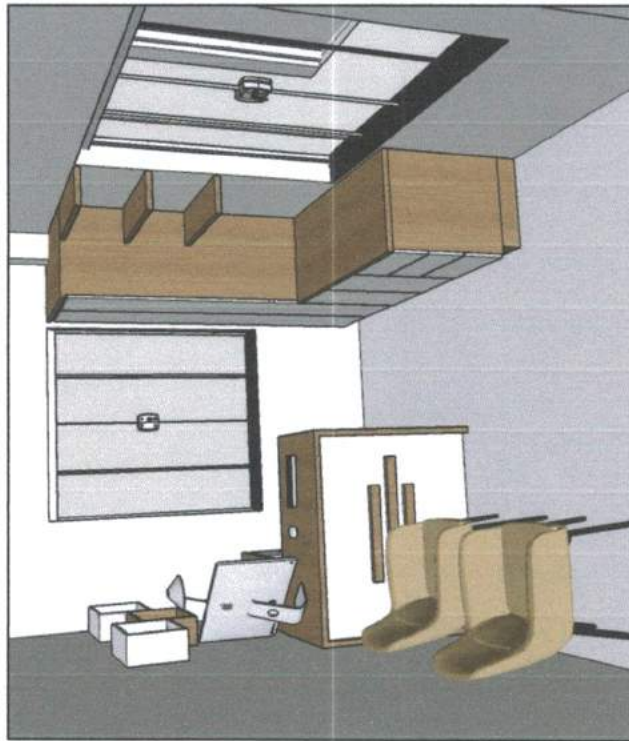

000092

ARQUITETO:

Arnildo Demuth Jr

CAU:

A 120850-0 CREAS

CLIENTE:

Atend. Familiar 02

ESCALA:

1/25

DATA:

26-07-2019

01 un Armário sem portas em MDF branco TX de 15mm, com prateleiras. (Fig 01)

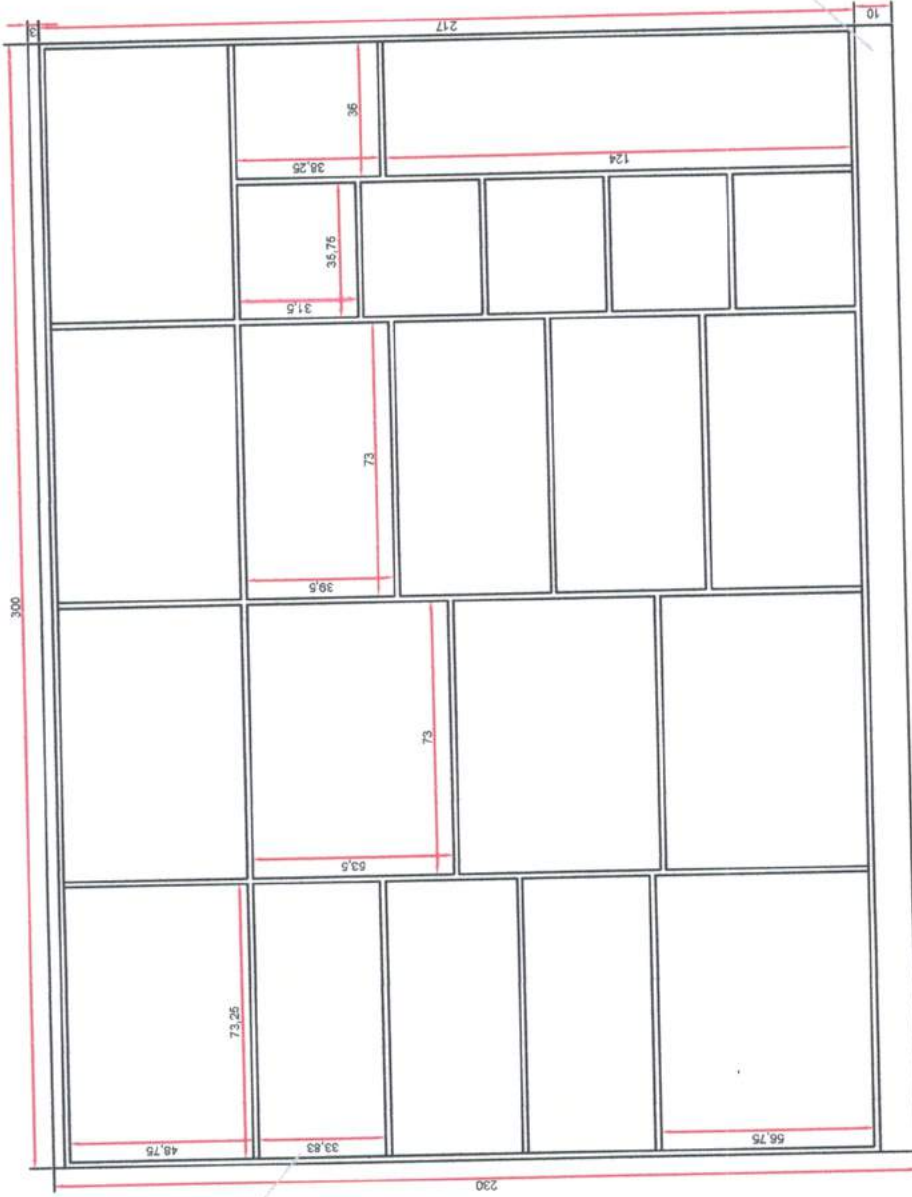

Vista frontal

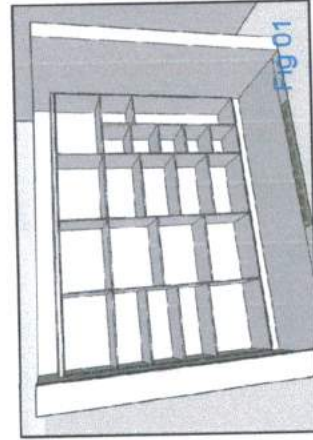

Rodapé em madeira de pinheiro revestido c/ fórmica branca TX

000093

Armário

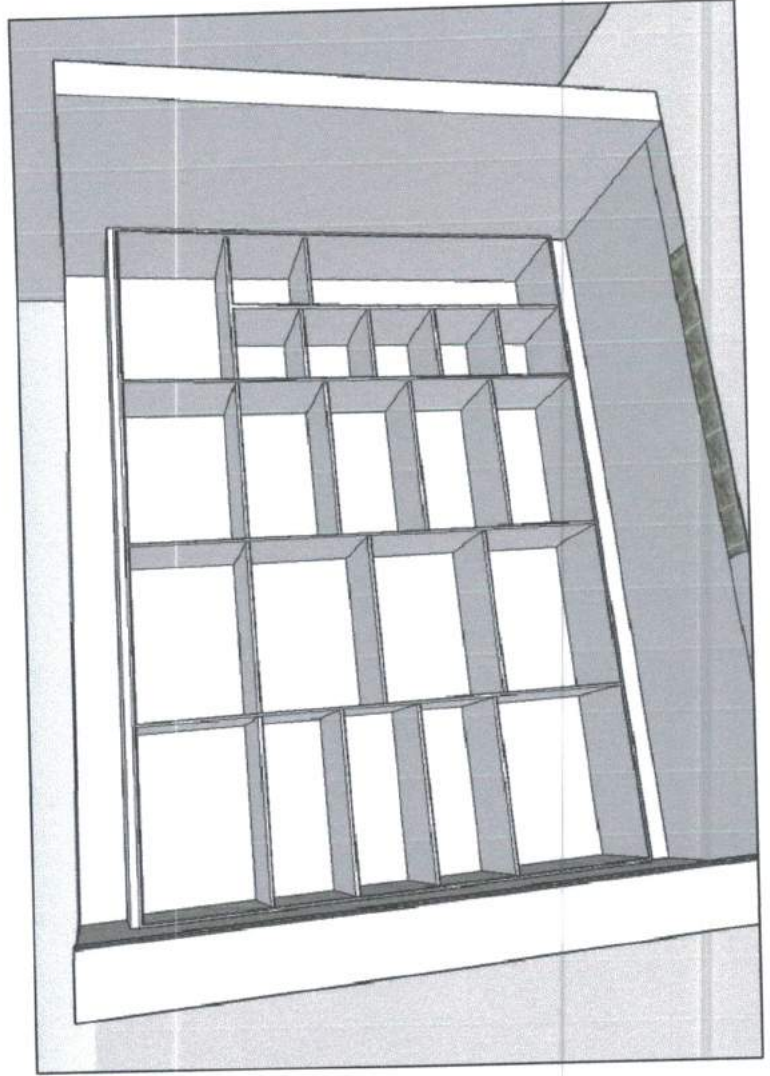

000094

ARQUITETO:

Arnildo Demuth Jr

CAU:

A 120850-0

CLIENTE:

CREAS

AMBIENTE:

ALMOXARIFADO

ESCALA: DATA:

1/20

26-07-2019

000095

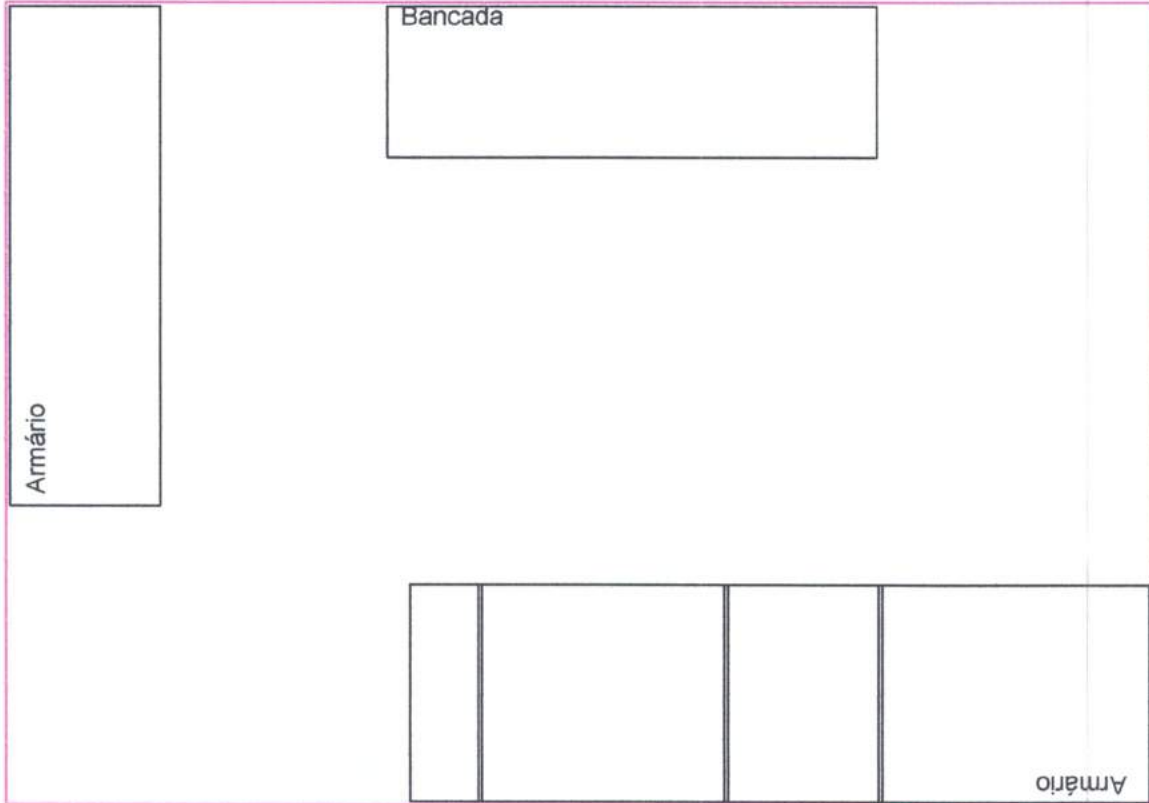
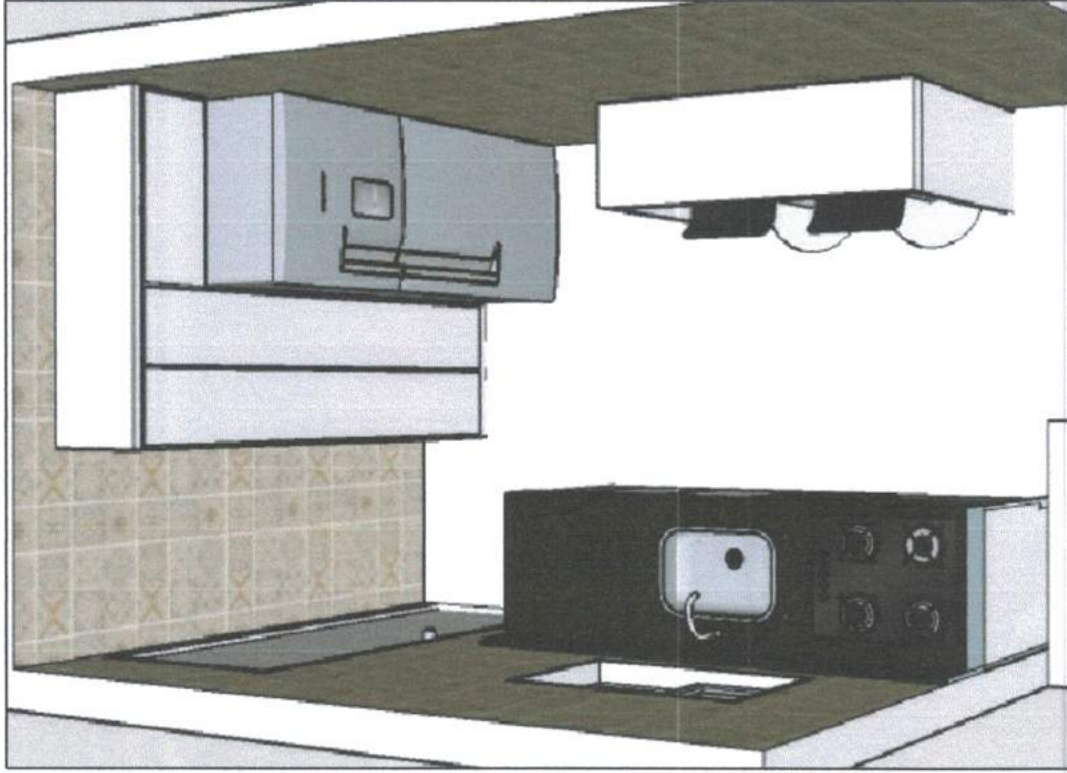

ARQUITETO:

Arnildo Demuth Jr

CAU:

A 120850-0

CLIENTE:

CREAS

AMBIENTE:

COZINHA

ESCALA:

1/20

DATA:

26-07-2019

01 un Armário em MDF branco TX, 15mm, com portas e prateleiras. (Fig. 02)

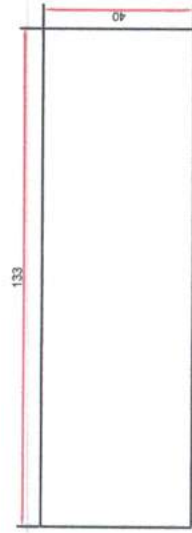

Vista superior

01 un Bancada em MDF branco, engrossado para 30mm, com tampo revestido com fórmica branca TX (FIG 02)

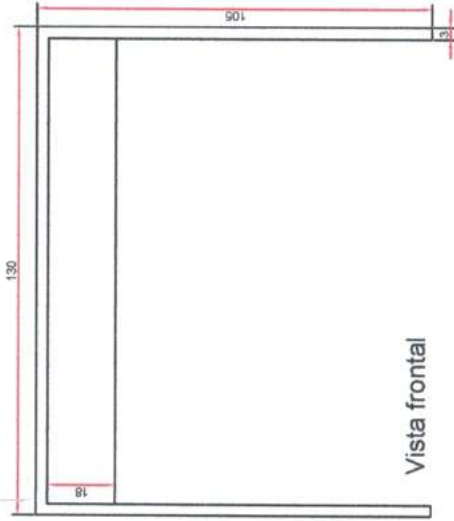

Vista frontal

Vista superior

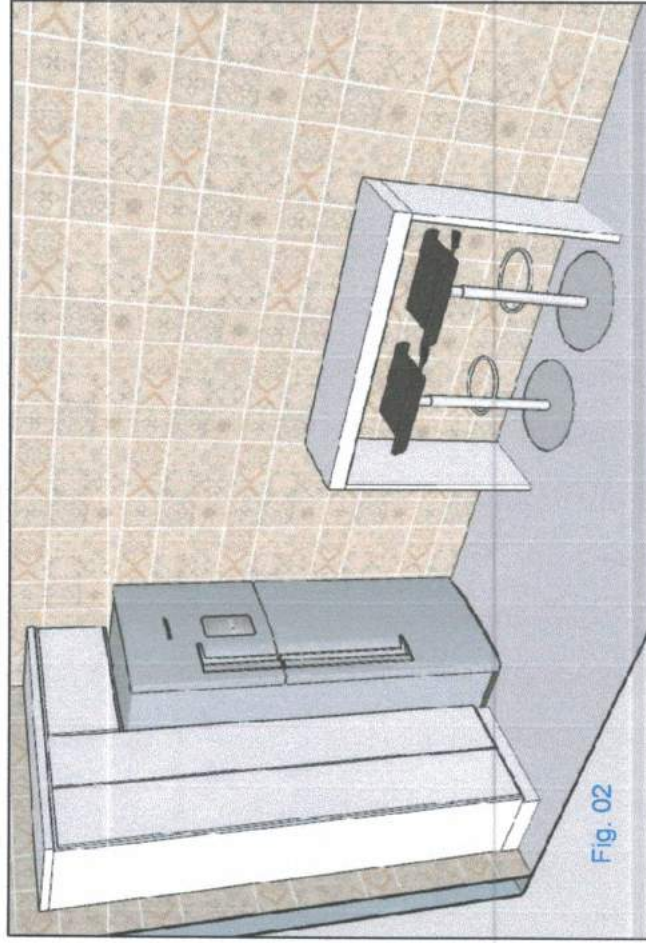
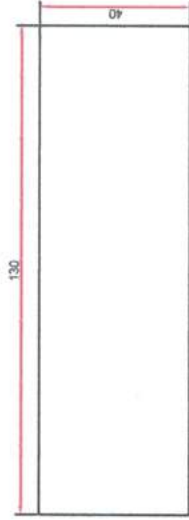

Fig. 02

000096

ARQUITETO:

Arnildo Demuth Jr

CAU:

A 120850-0 CREAS

CLIENTE:

COZINHA

AMBIENTE:

ESCALA:

1/20

DATA:

26-07-2019

01un Armário em MDF branco TX,
 15mm, com portas e gavetas
 (bancada da pia em granito existente) (Fig. 01)

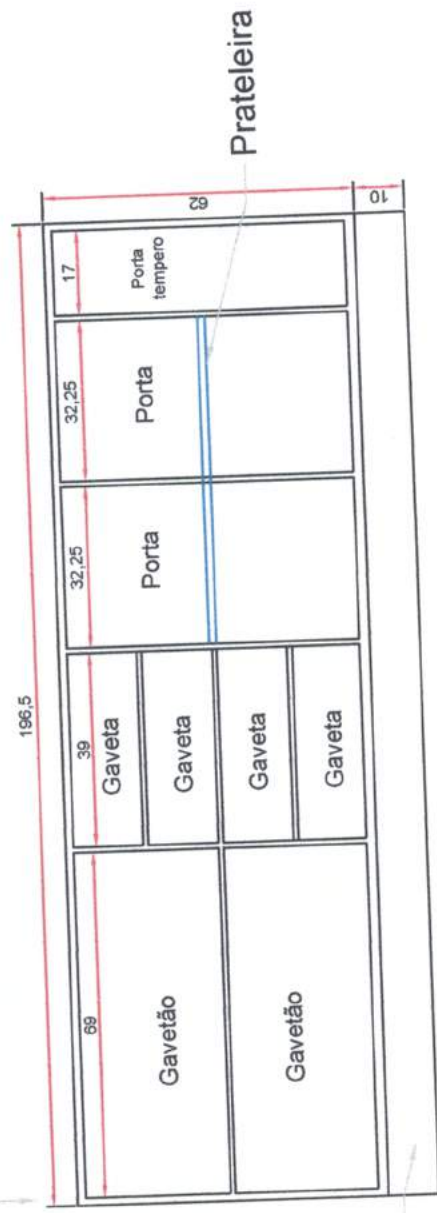

Rodapé em madeira
 de pinheiro revestido
 c/ fórmica branca TX

Vista frontal

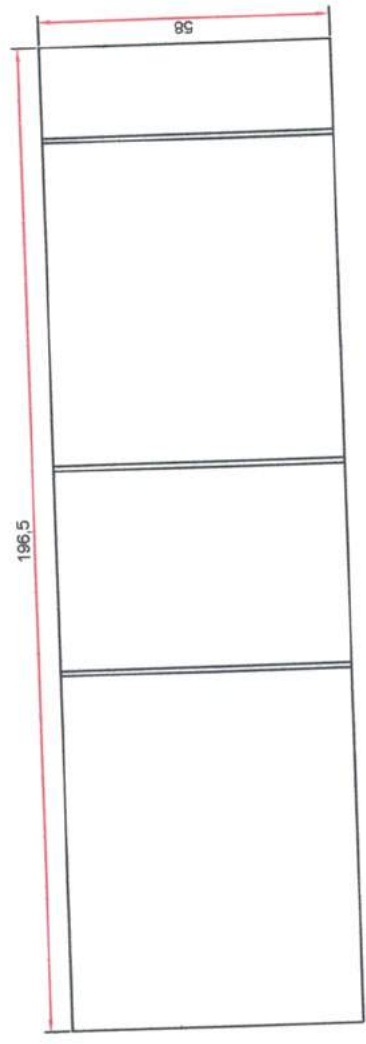

Vista superior

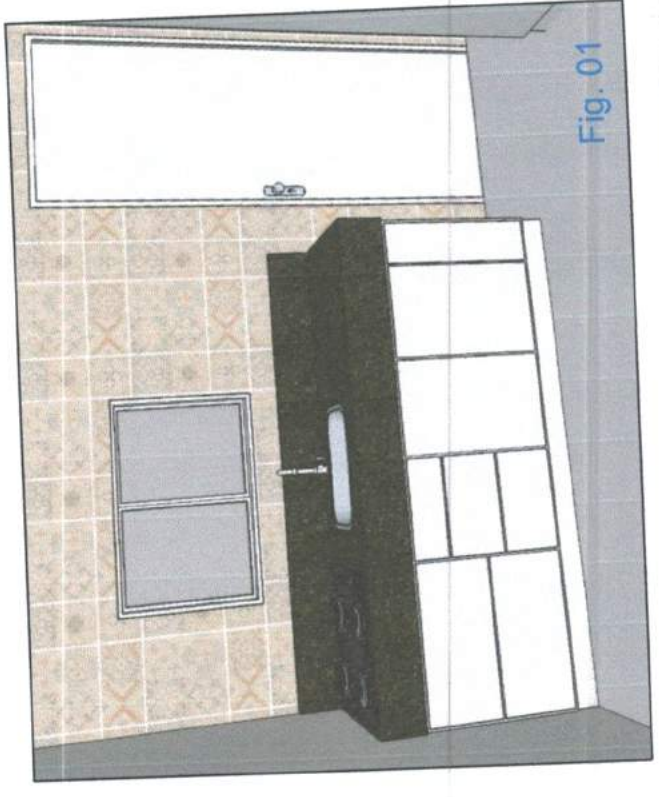

000097

PROJETO MOBILIÁRIO

CONSELHO TUTELAR

ARQUITETO: ARNILDO DEMUTH JR. CAU: 120850-0 CRUZ MACHADO - 2019

000098

02 un Escrivadinha em MDF com 4 gavetas, estrutura Cinza Cristal de 15mm, tampo e frente de gavetas em MDF Azul Soft de 15mm, puxador Gala metal polido 128mm, tampo engrossado com 30mm (Fig 01)

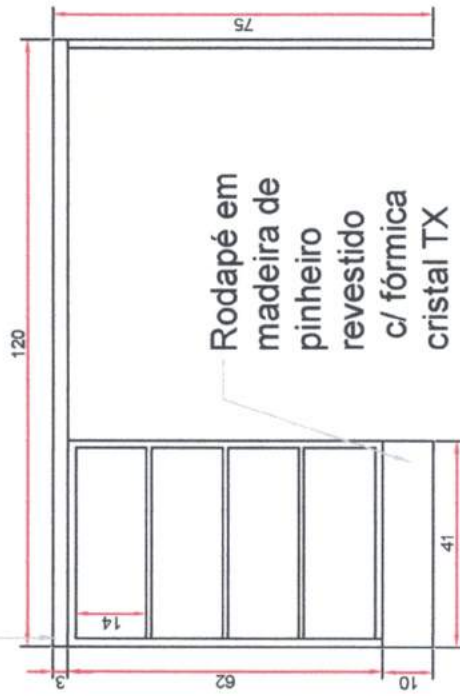

Vista frontal

Vista Superior

02un Mesa de apoio para impressora em MDF Cinza Cristal de 15mm, tampo de 30mm em MDF Azul Soft de 15mm (Fig 02)

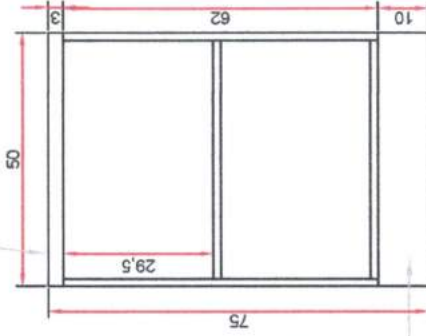

Vista frontal

Vista Superior

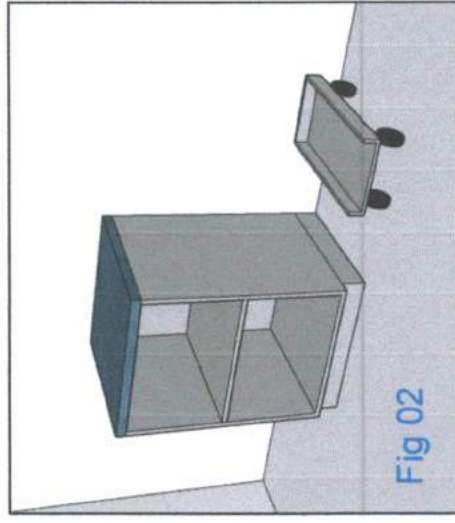
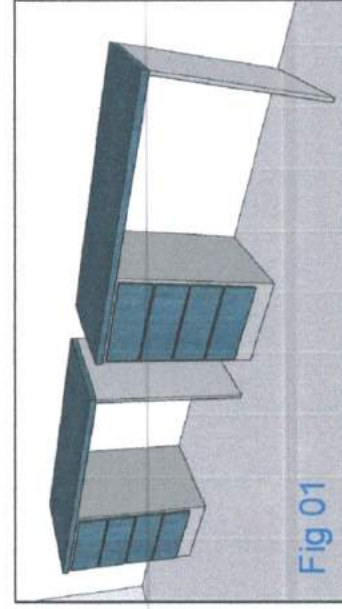

000099

02 un Escrivadinha em MDF com 4 gavetas, estrutura Cinza Cristal de 15mm, tampo e frente de gavetas em MDF Azul Soft de 15mm, puxador Gala metal polido 128mm, tampo engrossado com 30mm (Fig 03)

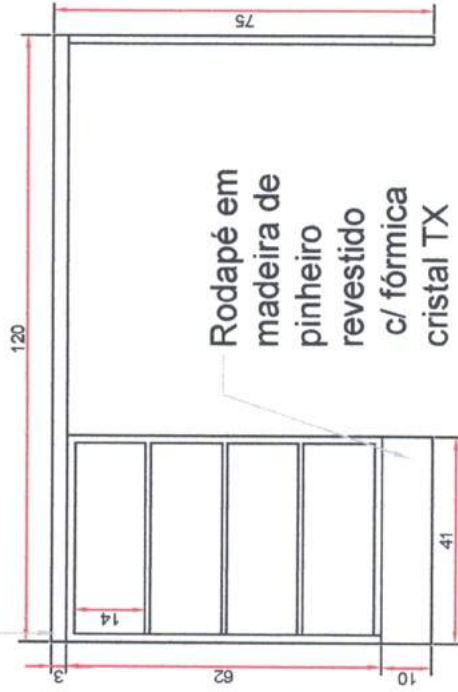

Vista frontal

Vista Superior

02 un Mesa de apoio para impressora em MDF Cinza Cristal de 15mm, tampo de 30mm em MDF Azul Soft de 15mm (Fig 04)

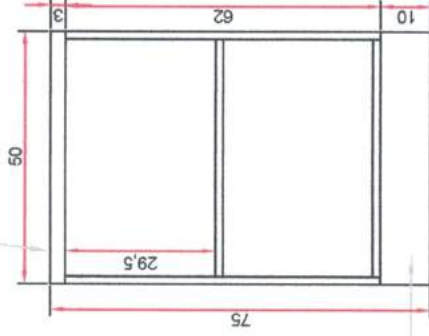

Vista frontal

Vista Superior

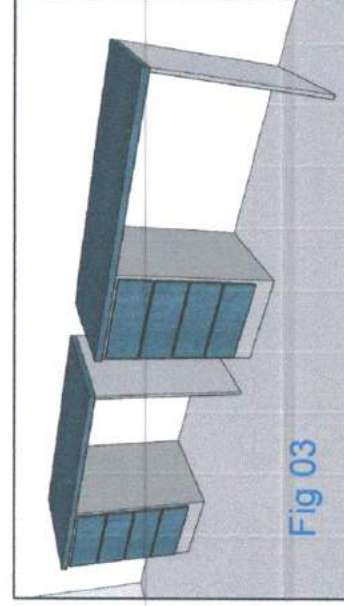

Fig 03

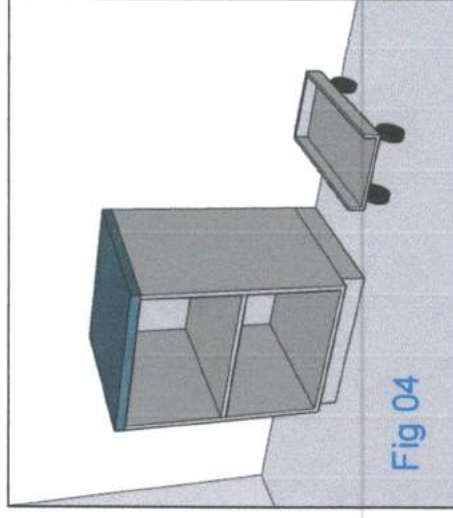
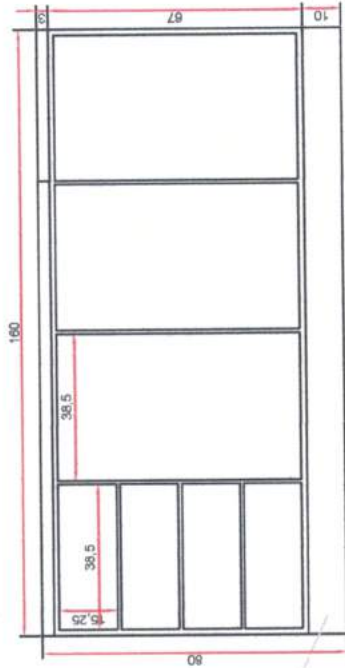

Fig 04

000100

01 un Armário em MDF, estrutura Cipres de 15mm, com 3 portas e 4 gavetas Jauzi, tampo em fórmica Granito preto puxador Gala metal polido 128mm (Fig 05)



Rodapé em madeira de pinheiro revestido c/ fórmica preta TX

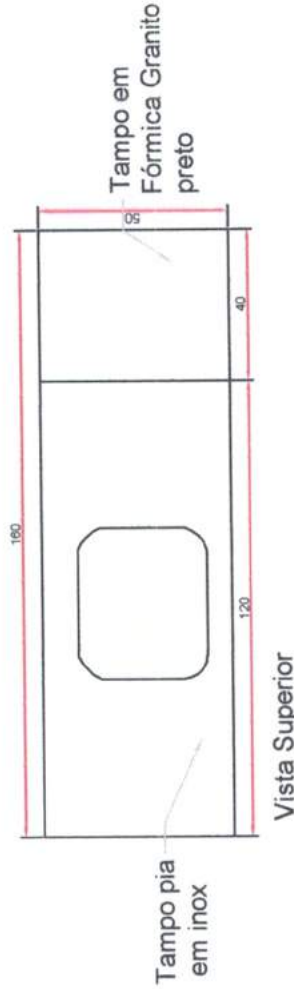

Tampo em Fórmica Granito preto

Tampo pia em inox

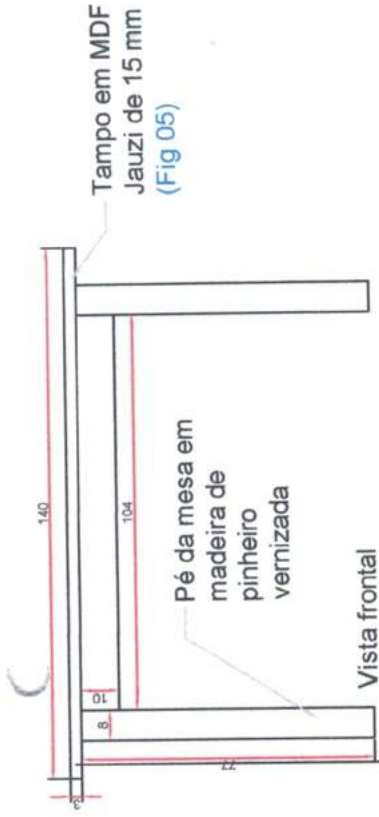
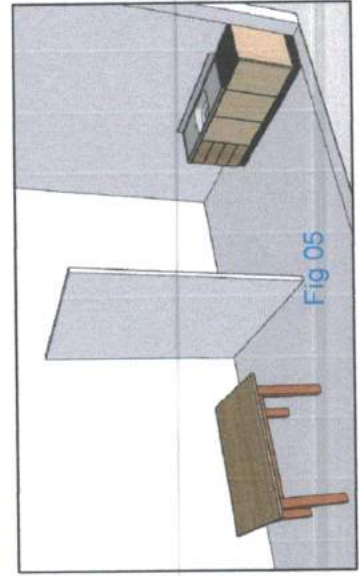

Tampo em MDF Jauzi de 15 mm (Fig 05)

Pé da mesa em madeira de pinheiro vernizada

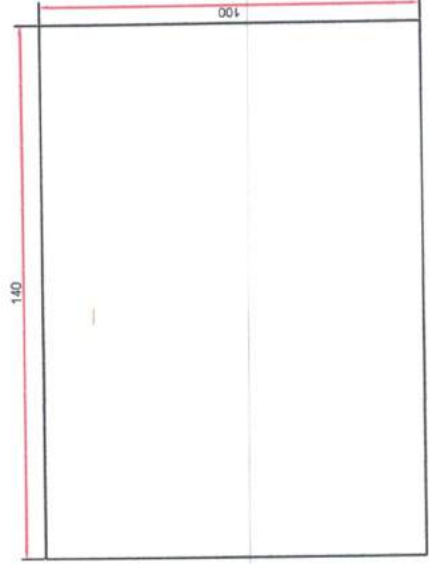
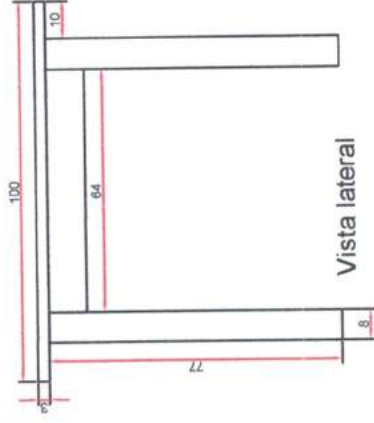

000101

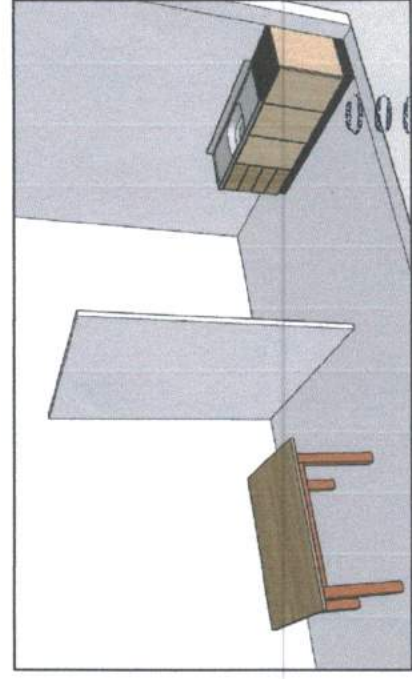
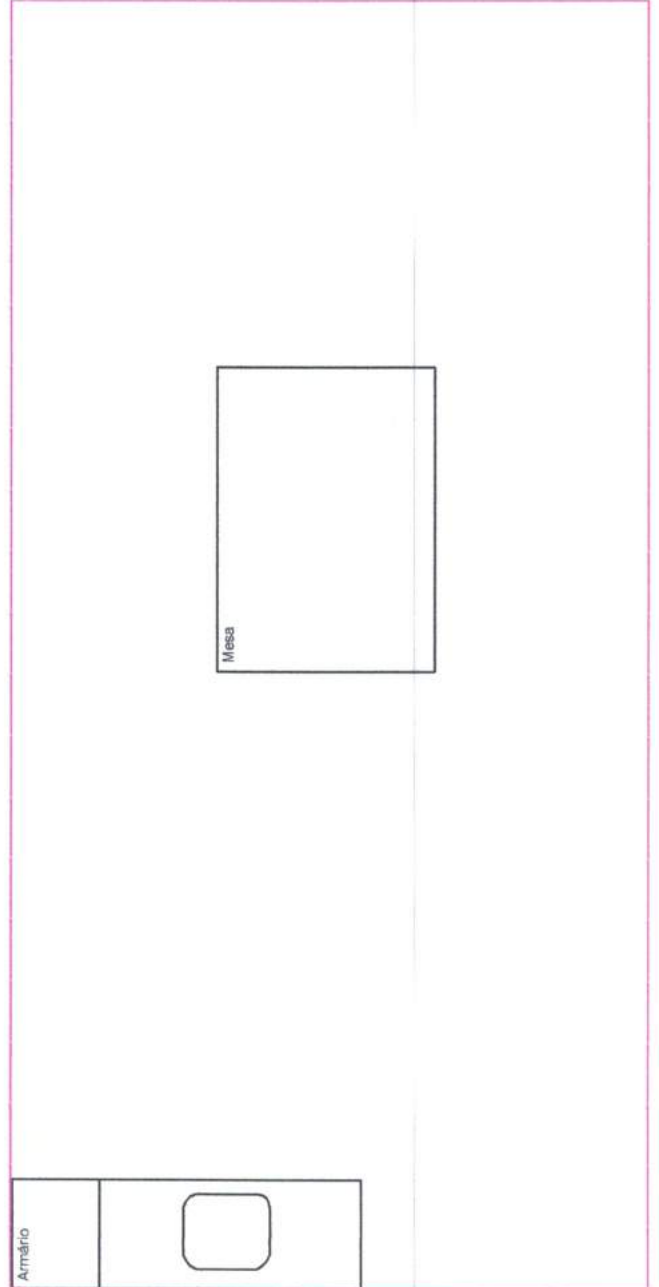
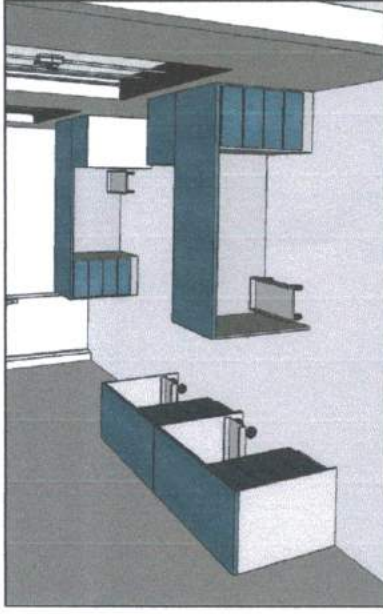
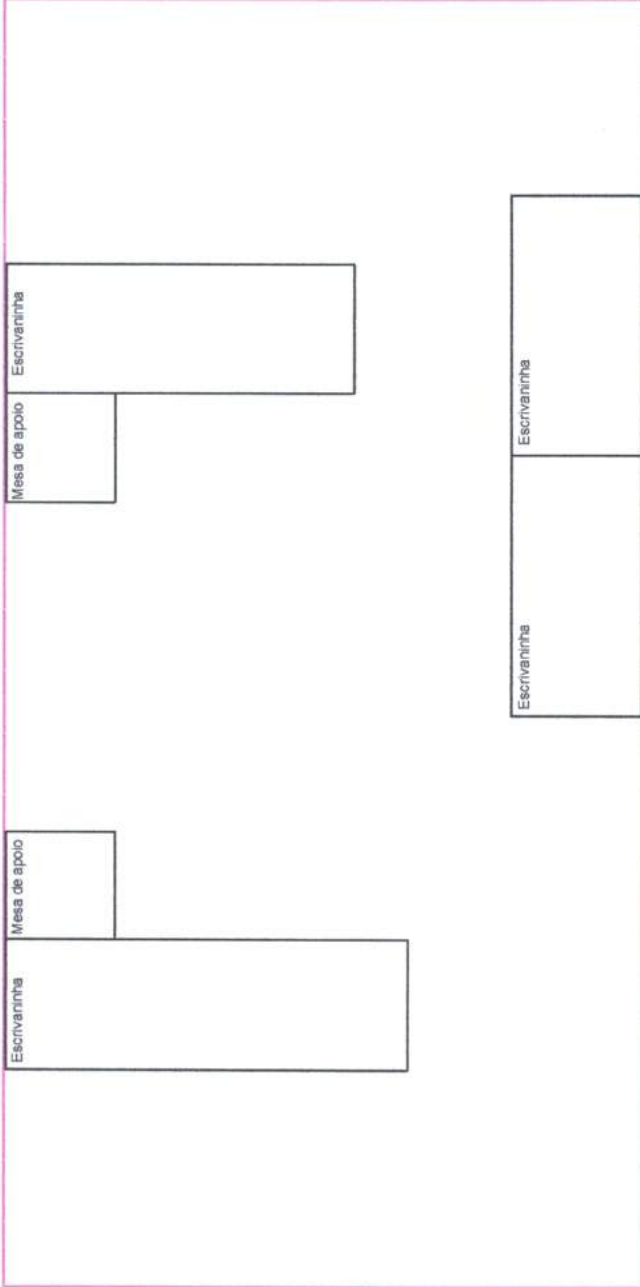

000102

ARQUITETO:

Arnildo Demuth Jr

CAU:

A 120850-0

CLIENTE:

CREAS

AMBIENTE:

CONSELHO TUTELAR

ESCALA:

1/35

DATA:

26-07-2019